

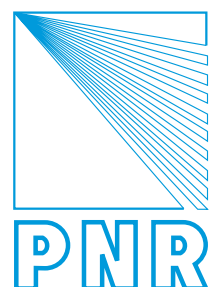

AIR ASSISTED ATOMIZERS

CTG AZ15 BR

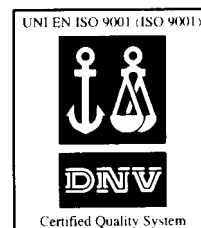

INTRODUCTION

INDEX

Page

| | |
|---|----|
| Introduction - Atomizing liquids and air assisted atomizers | 1 |
| Properties of an atomized spray | 2 |
| Ultrasonic atomizers | 3 |
| Atomizers and accessories | 4 |
| Atomizing units and carts | 5 |
| Classic atomizers | 6 |
| Set-ups and complete codes | 7 |
| Atomizing systems layout | 8 |
| Options and body styles | 9 |
| Pressure atomizers | 12 |
| Siphon atomizers | 15 |
| Large size atomizers | 18 |
| Accessories | 21 |
| Ambient humidification | 22 |

TECHNICAL PUBLICATIONS

PNR manufactures a complete range of spray nozzles for general industrial applications, as well as several products and systems based on the spray technology. Complete information about our Company and our product range is available through the following publications.

| | |
|--|-------------|
| PRODUCT RANGE | CTG TV10 BR |
| GENERAL PURPOSE SPRAY NOZZLES | CTG UG14 BR |
| AIR ASSISTED ATOMIZERS | CTG AZ15 BR |
| COMPLEMENTARY PRODUCTS AND ASSEMBLY FITTINGS | CTG AC14 BR |
| INDUSTRIAL TANK WASHING SYSTEMS | CTG LS14 BR |
| EVAPORATIVE COOLING LANCES | CTG LN14 BR |
| SPRAYDRY NOZZLES | CTG SP10 BR |
| STEELWORK NOZZLES | CTG SW04 BR |

As a result of continuous product improvement, our technical publications are regularly updated, and automatically mailed to Customers whose address is registered into our Catalogue Mailing List.

We shall gladly register your name, when you mail to the nearest PNR Office or Distributor the form on page 25 duly filled with the required information.

NOTES

Our products and their performances are continuously reconsidered and improved in order to keep up with the latest state of technology.

We regret not to be able to give our Customers previous advice about these modifications: for this reason the data and the product specifications given in this Catalogue are always to be understood as indicative, and do not firmly engage our Company.

In case your specific application should imperatively require that one or more characteristics of one of our products, as given by this Catalogue, is strictly adhered to, we ask you to obtain a written confirmation about your requirements before sending your order.

All information contained into this Catalogue, including product data, product codes, diagrams and photographs are the exclusive property of Flowtech srl.

It is forbidden to reproduce any part of this Catalogue without having obtained a written permission from Flowtech srl.

Dimensions in this Catalogue are given in millimeters (mm).

All threads are manufactured according to the ISO 228 standards (European norms BS 2779 – DIN 259 – UNI 338).

Explanations about the abbreviations used in the Catalogue are given at page 25.

All Trademarks used in this Catalogue are the property of their respective owners.

AIR ASSISTED ATOMIZATION

Many different industrial processes require some liquid to be atomized into fine or very fine drops.

This result may be obtained spraying the liquid using a purely hydraulic atomizer, where the liquid is forced through a small dimension orifice at high pressure.

Two major inconveniences are to be expected by such a method:

- A It requires costly high pressure pumps and lines.
- B The small orifice of an hydraulic atomizer is very easily clogged, impairing the system reliability.

In the vast majority of industrial processes air assisted atomizers are being used, where compressed air supplies the required energy for atomizing the liquid.

This technology, while relatively expensive, allows for production of fine and very fine droplets so as to satisfy the requirements of any industrial application.

An air atomizing system has however two inherent limitations:

- A Because of the narrow inside passages it requires water and air to be properly filtered at system inlet.
- B Because of the high speed of the spray, it is only possible to obtain jets with limited spray angles.
Multiple orifice air nozzles are shown later in this catalogue to overcome this problem.

AIR ASSISTED ATOMIZERS

The first two sections of this Catalogue show the two types of atomizers which are largely used in the industry for numberless applications.

ULTRASONIC ATOMIZERS

These devices provide liquid atomization through a two step process:

- A Liquid is ejected through a number of small orifices into the nozzle outlet channel, where a high velocity air stream provides for the first liquid breakup through shear action onto the jets surface.
- B The air stream carrying the droplets impacts onto a resonator placed in front of the nozzle outlet orifice, generating a field of high frequency sound waves.
Flying through the sound wave field, the droplets undergo an additional breakup step.

Ultrasonic atomizers produce very fine sprays, with drop dimensions contained into a limited range, and can supply low capacity sprays in the range from 100 lph down.

The sound waves generate a typical noise, which requires the local noise level to be tested lower than legally admissible levels by law.

CLASSIC ATOMIZERS

These devices obtain liquid atomization by simple shear action, providing a high velocity air stream to impact onto a liquid flow.

In spite of their inherent low efficiency, and because of the low flow rates involved, conventional atomizers are the most convenient solution for most of the current applications.

A wide range of spray patterns, atomizer types and accessories has been developed in the time to suit many different industry requirements.

HUMIDIFICATION SYSTEMS

The third part of this Catalogue shows efficient air humidification systems based on our atomizers range, including accessories and control panels.

INTRODUCTION

SPRAY PROPERTIES

The atomization of a liquid by means of a compressible fluid like air, steam or a gas, is defined pneumatic, two-phase or twin-fluid atomization.

Many industrial processes require the availability of fine atomized droplets and the techniques to produce finely atomized sprays have been largely improved in the recent years, with new types of atomizers being developed.

In addition, more sophisticated process techniques have heightened the demand for a precise definition about the characteristics of the spray, whose most interesting parameters are listed below, and are now made available to the design engineer.

Arithmetic Mean Diameter AMD (D10) This is the arithmetic mean value as calculated on the diameters from the total number of drops in the sample spray.

Volume Mean Diameter VMD (D30) The diameter of that drop whose volume has the same value as the arithmetic mean of volume values on the total number of drops in the spray.

Sauter Mean Diameter AMD (D32) The diameter of that drop whose Volume/Surface ratio value is the same as the arithmetic mean of Volume/Surface values on the total number of drops belonging to the sample spray under examination.

In addition the following histograms and diagrams are usually used to define a sample spray:

- Volume percentage cumulative curve
- Distribution Curve of droplet diameters
- Distribution curve of droplet velocities.

Above parameter values and information make it possible to base process calculations upon precise data about atomization degree, heat exchange efficiency and jet behaviour in a given operational ambient.

The knowledge of the Sauter Mean Diameter (SMD or D32) value is of special importance in heat exchange calculations for evaporative cooling processes, since it makes it possible to evaluate the liquid exchange surface obtained atomizing into drops a given liquid volume.

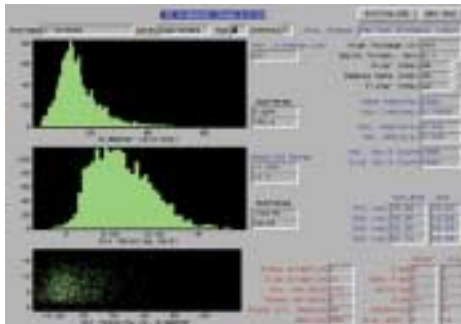

PNR can supply upon request complete documentation containing test reports about the aforementioned parameters and additional information, for all PNR atomizers.

The diagrams beside show the distribution of droplet diameters and droplet velocities of a spray under test as available to our customers.



In the photo beside a test being performed at our laboratories. We use a computer driven laser interferometer to detect and record the spray parameters, while fluid capacities and feed pressure values are monitored through high precision instruments.

NOTE

Capacities mentioned in this Catalogue refer to processes where water is atomized by means of compressed air: atomizer performances when different fluids are used have to be determined by means of specific laboratory tests.

ULTRASONIC ATOMIZER RANGE

The range of ultrasonic atomizers, together with accessories and complete units derived from ultrasonic atomizers are shown in the following pages.

Ultrasonic atomizers offer the following distinct advantages:

- A The droplets show not only a low mean value for SMD, but also a very narrow range for such SMD values. This means a very predictable spray behaviour, without drops much bigger or smaller than the spray SMD value : for example there will be no large drop falling to the ground before complete evaporation and causing a wet spot in an ambient humidification system.
- B The high variations in local air pressure induced by the sound waves prevent dust and lime particles from building up at the orifice and impairing atomizer performance.

A typical application for ultrasonic atomizers is in ambient humidification systems, as shown at page 22.



Page 4



Page 5

ULTRASONIC ATOMIZERS

NOZZLES AND ACCESSORIES

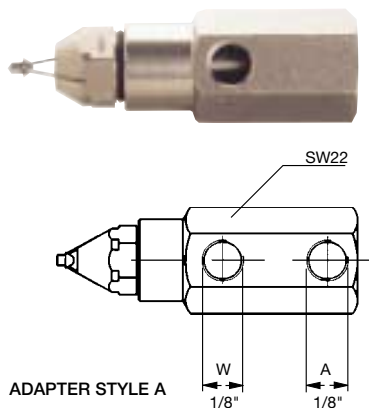

ADAPTER STYLE A

W = Water capacity (lpm)
A = Air capacity (N-cmph)

Ultrasonic atomizers MA series produce the finest atomized liquid sprays available for common industrial processes, as a full cone spray with a narrow spray angle.

Since water and compressed air are ejected from different orifices, their pressure values can be adjusted separately avoiding mutual influence: this allows for obtaining satisfactory operating conditions along a very wide range of fluid capacities.

Atomizer heads are normally assembled onto a style A adapter as shown in the diagram beside, while a choice of alternative adapter styles is given at the bottom of this page.

Materials Atomizer head B1 Aisi 303 stainless steel
Adapter B1 Aisi 303 stainless steel
 T1 Brass

ORDERING CODE

HEADS
The codes given in the capacity table beside refer to the atomizer head only, and can be used for ordering the head as a separate part.

ADAPTERS
Adapters can be ordered as separate parts completing their codes with the standard PNR material codes. Therefore replace xx with T1 for Brass and B1 for Aisi 303.

COMPLETE ATOMIZERS
To identify a complete atomizer, add to the head code the two digit suffix indicating the adapter style and material.

MAD 0801 B1 B C

Adapter material
A = T1 Brass
B = B1 Aisi 303

Adapter style
A = XMA 0103 xx
B = XMA 0101 xx
C = XMA 0102 xx
D = XMA 0100 xx

| Head Code | | Air pressure (bar) | | | | | | | | | | | |
|-------------|-------------|--------------------|-------------|------|------|------|------|------|------|------|------|------|------|
| | | W | A | W | A | W | A | W | A | W | A | | |
| 25° | MAD 0330 B1 | 2 | 0,10 | 3,1 | 0,12 | 3,0 | 0,15 | 3,1 | 0,27 | 2,7 | - | - | |
| | | 3 | 0,05 | 3,7 | 0,10 | 3,1 | 0,12 | 3,6 | 0,20 | 3,7 | 0,32 | 2,9 | |
| | | 4 | 0,02 | 4,7 | 0,05 | 4,8 | 0,08 | 4,4 | 0,18 | 4,4 | 0,25 | 4,2 | |
| | | 5 | - | - | 0,02 | 5,3 | 0,05 | 5,3 | 0,13 | 5,5 | 0,22 | 5,2 | |
| | | 6 | - | - | - | - | 0,02 | 6,1 | 0,12 | 6,0 | 0,18 | 5,8 | |
| | | 6 | 0,23 | 2,7 | 0,28 | 2,9 | 0,37 | 2,7 | 0,72 | 2,2 | - | - | |
| | MAD 0801 B1 | 3 | 0,22 | 3,6 | 0,27 | 3,6 | 0,32 | 3,5 | 0,52 | 3,2 | 0,82 | 2,7 | |
| | | 4 | 0,18 | 4,5 | 0,22 | 4,4 | 0,28 | 4,6 | 0,45 | 4,6 | 0,62 | 4,7 | |
| | | 5 | 0,12 | 5,4 | 0,18 | 5,3 | 0,25 | 5,6 | 0,40 | 5,4 | 0,53 | 5,4 | |
| | | 6 | 0,07 | 6,2 | 0,13 | 6,3 | 0,22 | 6,2 | 0,35 | 6,3 | 0,50 | 6,2 | |
| | | MAD 1131 B1 | 2 | 0,50 | 7,3 | 0,60 | 6,6 | 0,73 | 6,9 | 1,15 | 5,6 | - | - |
| | | | 3 | 0,40 | 9,7 | 0,50 | 9,5 | 0,65 | 9,4 | 0,96 | 9,3 | 1,35 | 7,9 |
| | 4 | | 0,27 | 11,6 | 0,37 | 11,9 | 0,55 | 11,8 | 0,93 | 12,1 | 1,20 | 11,5 | |
| | 5 | | 0,13 | 13,9 | 0,23 | 13,8 | 0,38 | 14,0 | 0,87 | 14,1 | 1,15 | 13,8 | |
| | 6 | | 0,07 | 18,6 | 0,13 | 18,7 | 0,27 | 8,7 | 0,72 | 18,9 | 1,10 | 19,0 | |
| | 40° | | MAL 0800 B1 | 2 | 0,18 | 2,7 | 0,23 | 2,7 | 0,32 | 2,9 | 0,73 | 2,1 | - |
| | | 3 | | 0,15 | 3,7 | 0,18 | 3,9 | 0,25 | 3,5 | 0,50 | 3,7 | 0,85 | 2,6 |
| | | 4 | | 0,10 | 4,5 | 0,17 | 4,6 | 0,22 | 4,9 | 0,33 | 4,8 | 0,53 | 4,4 |
| 5 | | 0,03 | | 5,4 | 0,10 | 5,6 | 0,18 | 5,4 | 0,30 | 5,4 | 0,45 | 5,3 | |
| 6 | | - | | - | 0,03 | 6,2 | 0,12 | 6,3 | 0,27 | 6,2 | 0,38 | 6,3 | |
| 6 | | 0,46 | | 7,3 | 0,52 | 7,2 | 0,68 | 6,8 | 1,13 | 5,7 | - | - | |
| MAL 1130 B1 | | 3 | 0,38 | 9,5 | 0,47 | 9,7 | 0,65 | 10,2 | 0,95 | 9,4 | 1,27 | 7,7 | |
| | | 4 | 0,23 | 11,8 | 0,35 | 11,8 | 0,50 | 11,9 | 0,88 | 12,1 | 1,15 | 11,8 | |
| | | 5 | 0,13 | 13,5 | 0,23 | 13,9 | 0,37 | 14,0 | 0,82 | 14,1 | 1,10 | 14,2 | |
| | | 6 | 0,07 | 16,0 | 0,13 | 16,2 | 0,27 | 16,2 | 0,63 | 16,2 | 1,03 | 16,3 | |
| | | MAL 1300 B1 | 2 | 0,95 | 14,6 | 1,12 | 16,5 | 1,40 | 16,3 | 2,42 | 10,4 | - | - |
| | | | 3 | 0,80 | 19,3 | 1,00 | 20,0 | 1,26 | 22,2 | 1,90 | 19,2 | 2,87 | 14,5 |
| 4 | | | 0,60 | 24,7 | 0,80 | 24,7 | 1,08 | 25,0 | 1,80 | 25,0 | 2,40 | 23,2 | |
| 5 | | | 0,42 | 29,9 | 0,60 | 30,3 | 0,90 | 30,4 | 1,70 | 30,5 | 2,27 | 29,9 | |
| 6 | | | 0,23 | 35,6 | 0,40 | 36,0 | 0,67 | 35,6 | 1,55 | 36,2 | 2,15 | 35,2 | |

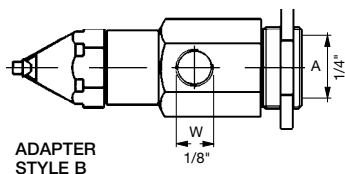

ADAPTER STYLE B

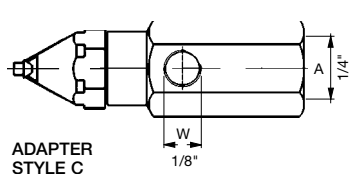

ADAPTER STYLE C

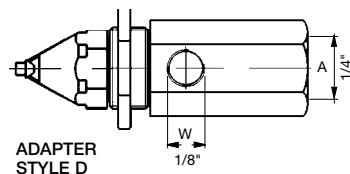

ADAPTER STYLE D

LOCKNUT FITS BOTH FRONT AND REAR THREADED BODIES.

Additional adapter styles offer different connecting options for connecting lines layout and for securing the atomizer when assembled through a wall, as shown below.

Locknut code VAC 0021 B1

ULTRASONIC ATOMIZERS

ATOMIZING CART

The atomizing cart allows access to areas where atomized liquids are required for providing ambient disinfection.

Our long experience with these applications has made it possible to combine ease of portability, long atomizing times, simple and reliable operation.

The stainless steel bottle, which is equipped with quick-coupling connections and a filling cover, contains both liquid supply and compressed air to provide pressure for the liquid line, while compressed air for atomizing must be available locally.

Two rubber lined wheels and a handle provide for convenient mobile capabilities.

The cart can be fitted with up to three MA atomizers, each one assembled onto a swivel joint for efficient spray orientation.

The unit can be driven both from an automatic PLC-driven and from a manual control cabinet, depending upon the application requirements.

Further details are shown on our data sheet 9121.

| | |
|-------------------------------|------------------|
| Weight | 13 kg |
| Pressure tank capacity | 19 liters |

ATOMIZING TROLLEY



CLASSIC ATOMIZERS



The following pages show our complete range of conventional atomizers, ie devices where the liquid jet is broken down into fine droplets by shear action from a jet of impinging high velocity air.

Because of the many different application requirements, several options are available to provide the most suitable atomizer: some of those options are shown later on in this Catalogue.



Page 7

ATOMIZER SET-UP

The set-up is the actual atomizer, that is the device where the liquid flow and the air flow come to impact with each other and originate the mist spray.

A set-up is composed of a liquid nozzle and an air nozzle, whose dimensions are matched together in order to assure the desired value for flow rate, type of jet and spray angle.

Several types of set-ups are available, whose specifications are given in the following pages.



Page 8

BODY TYPES

The atomizer body serves the purpose of conveniently connecting the set-up to the feed lines for air and water, and it may include several optional devices like shut-off needles or orifice cleaning needles.

MX series bodies include an air operated cylinder for remote operation.

Our standard range of manual or automatic bodies, including additional options, is shown in the following pages.



Page 21

ACCESSORIES AND OPTIONS

Atomizer accessories, special coatings and body options to cope with specific requirements are shown later on in this catalog.

Special coatings offer increased inner surface resistance to wear and lime build up, allowing for longer time between maintenance operations.



Page 24

CONTROL CABINET

Our self contained cabinets offer a proven and professional tool to adjust your atomizing system for optimized operation. See detailed description at page 24.

CLASSIC ATOMIZERS

SPRAY SET-UP

A spray set-up is composed of two parts, an air nozzle and a liquid nozzle. When assembled, the air nozzle fits precisely onto the liquid nozzle and the combination of the two provides the required geometry to originate the spray.

Such parameters as the number, the size and the profile of their orifices determine all the characteristics of the atomized spray which is produced by that given set-up, as follows:

The flow rate tables in the following catalogue pages show the spray set-up codes and their operational characteristics (air and liquid flow rates versus feeding pressures, and approximate spray dimensions).

Spray dimensions, taken in still air, are given for different values of air pressure with indication of maximum throw, and distance up to which the spray remains coherent.

TYPE OF JET



| | | |
|------------------------|------------------|------------------------|
| PRINCIPLE OF OPERATION | Internal mix | See page 9 |
| | External mix | |
| TYPE OF WATER FEEDING | Pressure feeding | See diagrams at page 9 |
| | Siphon feeding | |

SET-UP PARTS

The set-up code, as given from the Catalogue and completed with the material code, can be used to order air and liquid nozzles together.

Under each set-up code, the catalogue tables show single codes for air (An) and liquid (Ln) nozzles, so that these parts can be ordered separately if replacement is needed.

The locknut and the Teflon seal used for assembling the two nozzles can be ordered too as spare parts, specifying the codes given beside.

All PNR set-up parts are interchangeable and can always be matched together, even when made out of different materials. That makes it possible, for example, to match a wear resistant stainless steel set-up with a cost effective brass body.

SCREW-CAP AIR NOZZLE LIQUID NOZZLE SEAL

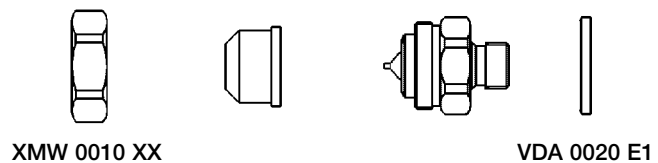

| | |
|--------------------|-----------------|
| Set-up Code | SUB 1520 |
| Ln XMW 5001 | Liquid nozzle |
| An XMW 4001 | Air nozzle |

COMPLETE ATOMIZER CODE

Once the desired spray characteristics have been identified (the right set-up has been chosen), the set-up code needs to be completed with the body and the option codes to precisely identify the complete atomizer code.

There are basically two types of body available, on which a set-up can be assembled:

BASIC BODY The body serves the only purpose of connecting the set-up with the air and liquid feed lines. The plug on the back of the body can be replaced by different kinds of devices, allowing to shut off or clean the liquid nozzle.

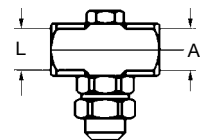

AUTOMATIC BODY Here the body has a built in pneumatic cylinder, which allows for starting and stopping the spray operation from a remote location. Shut-off only needle, cleaning needle, and single air inlet are the available options.

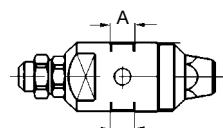

CLASSIC ATOMIZERS

ATOMIZER FEEDING

An atomizing system can be built so that the liquid is fed to the atomizer under pressure, or it can be alternatively obtained from an ambient pressure container. This is accomplished either by gravity feed or by liquid siphoning.

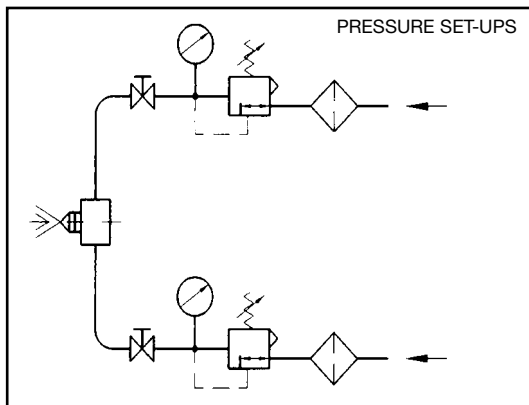

PRESSURE SET-UPS

These are used in most applications, with a wide range of spray patterns and flow rate values available.

Atomizing flow rates and droplet dimensions are obtained by adjustment of the pressure value in the two fluids.

At a given liquid pressure, the air pressure can be adjusted until the best suited flow rate values and droplet size are reached.

As an example, increasing air pressure will reduce the liquid flow rate, and produce finer droplets.

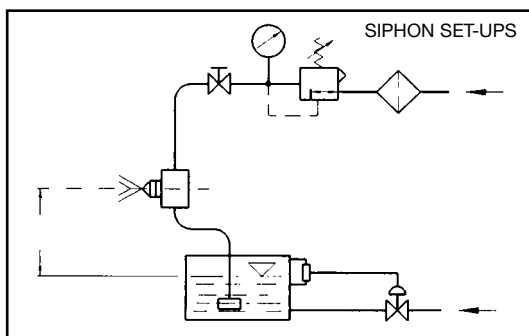

SIPHON SET-UPS

These set-ups deliver the lowest possible flow rates for an air assisted atomizer and allow for a very simple system lay-out.

They make it possible to spray additives in a simple way from an ambient pressure container.

The same adjustment procedure for atomizing conditions applies for the pressure set-ups.

In addition, the liquid flow rate can be changed adjusting the height of the liquid container with respect to the atomizer, both on siphon and on gravity feed.

PRINCIPLE OF OPERATION

The set-up can be so designed that air and liquid are mixed inside the atomizer, and ejected through the same orifice, or that air and liquid impact, mix and generate the atomized spray after having been ejected from the atomizer through separate orifices.

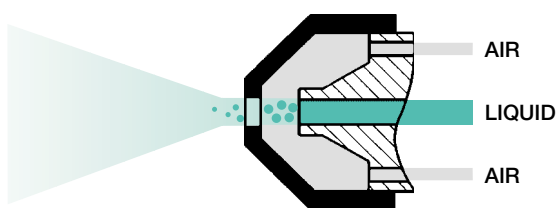

INTERNAL MIX SET-UPS

The most commonly used type, with a wide range of flow values and spray patterns available.

The set-up is designed in such a way that two fluids come in contact inside the nozzle, and the resulting mist spray exits from the nozzle orifice (s).

In these set-ups, changes in the pressure value of one of the fluids will affect the flow rate of the other one.

Increasing air pressure will result in lower liquid flow rate and finer droplets, and vice-versa.

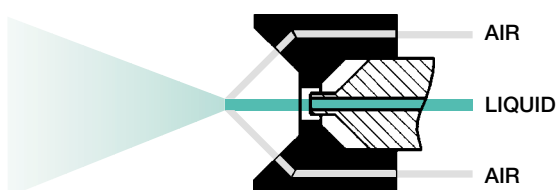

EXTERNAL MIX SET-UPS

Here the two fluids exit from separate orifices, they impact and mix outside the nozzle, pressure values can be easily and independently adjusted and their flow rates easily controlled.

Also, viscous or contaminated liquids can generally be atomized with an external mix set-up.

Increase in air pressure will result in finer atomization, but normally the spray droplet size is slightly larger as compared to an internal mix set-up.

These set-ups can only produce a flat spray pattern.

MW

BODY TYPES AND OPTIONS

BASIC BODY

COMPLETE CODE





- Replace the first two letters in the set-up code (SU) with the body code (MW).
- Add the material code for the material you require.
- Add the codes for the required options, if any.

MWB 1520 **B1** **B**

MATERIALS

- B1 = Aisi 303 Grade stainless steel
- D1 = PVC
- E6 = Lucite
- T8 = Nickel plated

OPTIONS

- A  STANDARD
- B  SHUT-OFF NEEDLE
- C  CLEANING NEEDLE
- D  CLEANING AND SHUT-OFF NEEDLE

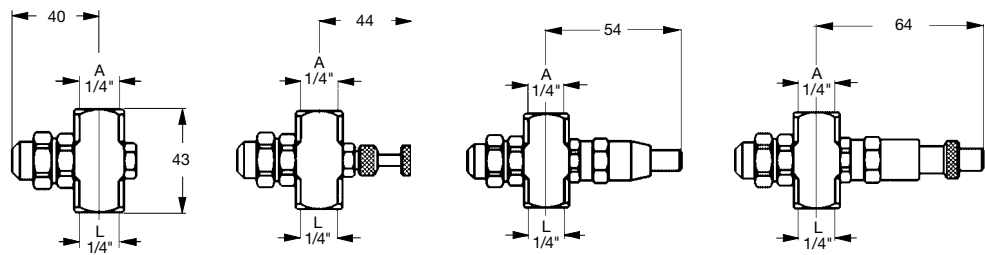

A = 1/4" Air inlet
L = 1/4" Water inlet

BODY TYPES AND OPTIONS

MX

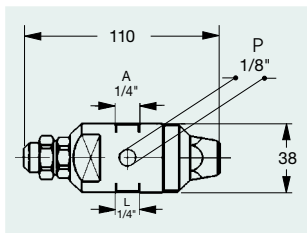

STANDARD SIZE

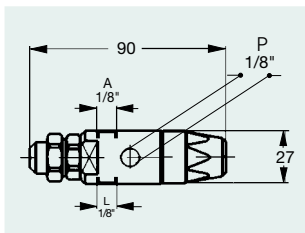

MINI SIZE

- A = Atomizing air inlet
- L = Water inlet
- P = Cylinder air inlet



AUTOMATIC BODY

MX automatic bodies have a built-in pneumatic cylinder, which controls the spray operation by means of a needle opening and closing the water inlet of the liquid nozzle.

Normally atomizing air is let to flow continuously, while cylinder command air is used to start and stop liquid atomizing cycles. For longer idle times between two atomizing cycles, where too much atomizing air would be wasted while liquid is not being atomized, sequenced shut-off should be provided for the two air lines.

That means atomizing air is shut-off after liquid shut-off, and it is started before the liquid is: this procedure avoids liquid dripping at the end of atomizing cycle.

See also "Single air inlet body" option, page 21.

UNIQUE NO-DRIP NEEDLE

Other manufacturers offer conventional shut-off needles. These needles try to stop water flow through contact between two stainless steel conical surfaces, which results obviously into dripping.

Our engineers developed a unique needle to assure positive water shut-off and completely drip free operation, and solved this problem completely (Italian patent MI 96U – 000541).

All PNR automatic atomizers include this better and more consistent design.

COMPLETE CODE

- Replace the first two letters in the set-up code (SU) with the body code (MX).
- Add the material code for the material you require.
- Add the codes for the required options, if any.

MXB 1520 B1 B

MATERIALS

- B1 = AISI 303 Grade stainless steel
- T8 = Nickel plated brass

OPTIONS

- A SHUT-OFF NEEDLE
- B CLEANING NEEDLE
- MA SHUT-OFF NEEDLE, SMALL BODY
- MB CLEANING NEEDLE, SMALL BODY

INTERNAL MIX SET-UPS

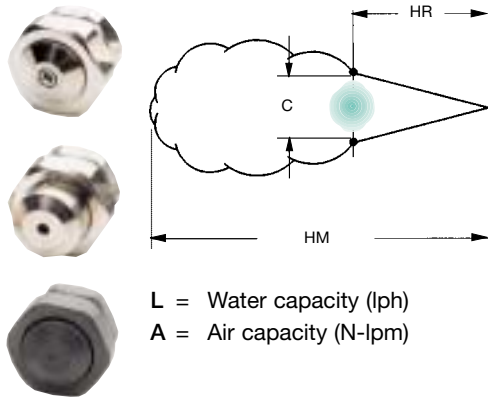

L = Water capacity (lph)
A = Air capacity (N-lpm)

FULL CONE SPRAY

These single orifice set-ups produce narrow angle full cone shaped atomization, with a spray angle value of about 20°.

More precise details are given in the jet dimension table on the right of the page.

Jet length can reach between 2500 and 9000 mm depending upon set-up size and operating conditions.

See advice on adjustment for flow rates and droplet size at page 8.

- Materials**
- T8 Nickel plated brass
 - B1 AISI 303 stainless steel
 - B3 AISI 316 stainless steel
 - D1 PVC
 - E6 Lucite

| Set-up Code | Air pressure (bar) | | | | | | | | | | | | | | | | | | | |
|-----------------|--------------------|------|------|-----|------|------|------|------|------|------|------|------|------|-----|------|-----|------|------|----|---|
| | L | | A | | L | | A | | L | | A | | L | | A | | PA | PL | HR | C |
| SUB 1520 | 0,7 | 2,5 | 15,6 | 1,4 | 6,4 | 13,9 | 2,7 | 6,2 | 23,0 | 3,5 | 7,8 | 28,0 | - | - | - | - | - | - | - | - |
| | 0,9 | 1,8 | 19,0 | 1,7 | 5,5 | 16,7 | 2,8 | 5,7 | 25,0 | 3,7 | 7,3 | 29,0 | 0,9 | 0,7 | 300 | 68 | 2700 | - | - | - |
| | 1,0 | 1,4 | 22,0 | 2,0 | 4,5 | 19,8 | 3,0 | 5,2 | 27,0 | 3,9 | 6,4 | 33,0 | 1,7 | 1,5 | 330 | 75 | 3000 | - | - | - |
| | - | - | - | 2,2 | 3,4 | 24,0 | 3,1 | 4,7 | 29,0 | 4,2 | 5,5 | 38,0 | 2,5 | 2,0 | 360 | 82 | 3400 | - | - | - |
| | Ln XMW 5001 | - | - | - | 2,4 | 3,0 | 26,0 | 3,2 | 4,3 | 31,0 | 4,5 | 4,5 | 43,0 | 3,1 | 3,0 | 390 | 96 | 3800 | - | - |
| An XMW 4001 | - | - | - | 2,5 | 2,5 | 28,0 | 3,4 | 3,9 | 33,0 | 4,6 | 4,1 | 45,0 | 4,5 | 4,0 | 440 | 116 | 4400 | - | - | - |
| - | - | - | 2,7 | 2,3 | 31,0 | 3,7 | 3,0 | 38,0 | 4,8 | 3,7 | 47,0 | - | - | - | - | - | - | - | - | - |
| SUB 1670 | 0,7 | 2,5 | 18,7 | 1,7 | 6,7 | 29,0 | 2,2 | 9,2 | 34,0 | 2,8 | 11,9 | 39,0 | - | - | - | - | - | - | - | - |
| | 0,9 | 2,0 | 22,0 | 1,8 | 6,4 | 31,0 | 2,5 | 8,2 | 39,0 | 3,1 | 11,0 | 43,0 | 0,9 | 0,7 | 430 | 90 | 3700 | - | - | - |
| | 1,0 | 1,6 | 26,0 | 2,0 | 5,9 | 34,0 | 2,8 | 7,2 | 44,0 | 3,4 | 10,1 | 47,0 | 1,5 | 1,5 | 460 | 105 | 4000 | - | - | - |
| | - | - | - | 2,1 | 5,2 | 37,0 | 3,0 | 6,7 | 47,0 | 3,7 | 9,2 | 52,0 | 2,4 | 2,0 | 480 | 109 | 4300 | - | - | - |
| | Ln XMW 5001 | - | - | - | 2,2 | 4,8 | 40,0 | 3,1 | 6,3 | 49,0 | 3,9 | 8,4 | 58,0 | 3,0 | 3,0 | 510 | 116 | 4600 | - | - |
| An XMW 4002 | - | - | - | 2,4 | 4,3 | 43,0 | 3,2 | 5,9 | 52,0 | 4,2 | 7,6 | 62,0 | 3,9 | 4,0 | 560 | 147 | 5200 | - | - | - |
| - | - | - | 2,7 | 3,6 | 48,0 | 3,4 | 5,5 | 55,0 | 4,5 | 6,8 | 68,0 | - | - | - | - | - | - | - | - | - |
| SUB 2142 | 0,9 | 4,8 | 21,0 | 2,0 | 10,7 | 33,0 | 2,7 | 16,5 | 37,0 | 3,4 | 20,0 | 43,0 | - | - | - | - | - | - | - | - |
| | 1,1 | 4,1 | 27,0 | 2,1 | 9,8 | 37,0 | 2,8 | 15,4 | 38,0 | 3,7 | 18,4 | 47,0 | 1,5 | 0,7 | 480 | 100 | 4000 | - | - | - |
| | 1,4 | 3,4 | 33,0 | 2,4 | 8,2 | 42,0 | 3,1 | 13,6 | 43,0 | 3,9 | 16,8 | 50,0 | 2,5 | 1,5 | 510 | 116 | 4300 | - | - | - |
| | 1,5 | 3,1 | 35,0 | 2,7 | 6,8 | 48,0 | 3,4 | 11,8 | 49,0 | 4,2 | 15,2 | 55,0 | 3,0 | 2,0 | 530 | 120 | 4600 | - | - | - |
| | 1,7 | 3,0 | 39,0 | 3,0 | 5,9 | 55,0 | 3,7 | 10,4 | 55,0 | 4,5 | 13,8 | 60,0 | 3,4 | 3,0 | 560 | 137 | 4900 | - | - | - |
| Ln XMW 5002 | 1,8 | 2,9 | 41,0 | 3,2 | 5,0 | 59,0 | 3,9 | 9,1 | 61,0 | 4,8 | 12,4 | 65,0 | 4,2 | 4,0 | 600 | 158 | 5300 | - | - | - |
| An XMW 4002 | 2,0 | 2,8 | 44,0 | 3,5 | 4,1 | 65,0 | 4,2 | 7,9 | 65,0 | 4,9 | 11,8 | 68,0 | - | - | - | - | - | - | - | - |
| SUC 2376 | 1,1 | 13,0 | 76,0 | 2,8 | 20,0 | 136 | 3,4 | 32,0 | 149 | 4,6 | 37,0 | 193 | - | - | - | - | - | - | - | - |
| | 1,4 | 8,9 | 91,0 | 3,1 | 16,3 | 149 | 3,9 | 25,0 | 170 | 5,3 | 29,0 | 220 | 1,7 | 0,7 | 660 | 209 | 4900 | - | - | - |
| | 1,5 | 7,2 | 98,0 | 3,4 | 11,9 | 163 | 4,6 | 15,9 | 205 | 5,6 | 25,0 | 235 | 2,8 | 1,5 | 760 | 268 | 6100 | - | - | - |
| | 1,7 | 5,8 | 105 | 3,9 | 7,0 | 187 | 5,3 | 9,1 | 240 | 6,0 | 21,0 | 250 | 3,9 | 2,0 | 810 | 286 | 6700 | - | - | - |
| | 1,8 | 4,7 | 112 | 4,2 | 4,7 | 205 | 5,6 | 6,8 | 255 | 6,3 | 17,4 | 270 | 5,3 | 3,0 | 910 | 337 | 7900 | - | - | - |
| Ln XMW 5003 | 2,0 | 3,6 | 119 | 4,6 | 3,0 | 220 | 6,0 | 5,0 | 275 | 6,7 | 14,0 | 290 | 6,0 | 4,0 | 970 | 359 | 9100 | - | - | - |
| An XMW 4003 | 2,1 | 2,7 | 127 | - | - | - | 6,3 | 3,6 | 290 | 7,0 | 11,0 | 305 | - | - | - | - | - | - | - | - |
| SUC 2690 | 0,9 | 31,0 | 57,0 | 2,1 | 53,0 | 96,0 | 2,7 | 80,0 | 103 | 3,8 | 88,0 | 135 | - | - | - | - | - | - | - | - |
| | 1,0 | 25,0 | 66,0 | 2,4 | 41,0 | 112 | 3,0 | 69,0 | 117 | 4,2 | 73,0 | 156 | 1,0 | 0,7 | 610 | 182 | 4900 | - | - | - |
| | 1,1 | 18,5 | 75,0 | 2,7 | 31,0 | 127 | 3,2 | 59,0 | 130 | 4,6 | 61,0 | 176 | 1,8 | 1,5 | 690 | 218 | 5800 | - | - | - |
| | 1,3 | 12,9 | 85,0 | 2,8 | 26,0 | 136 | 3,5 | 49,0 | 146 | 4,9 | 48,0 | 196 | 2,8 | 2,0 | 760 | 268 | 6700 | - | - | - |
| | - | - | - | 3,0 | 22,0 | 144 | 3,7 | 44,0 | 154 | 5,3 | 39,0 | 215 | 3,5 | 3,0 | 790 | 278 | 7000 | - | - | - |
| Ln XMW 5004 | - | - | - | - | - | - | 3,8 | 37,0 | 161 | 5,6 | 31,0 | 240 | 4,9 | 4,0 | 910 | 337 | 8500 | - | - | - |
| An XMW 4003 | - | - | - | - | - | - | 3,9 | 35,0 | 170 | 6,0 | 23,0 | 260 | - | - | - | - | - | - | - | - |
| SUC 3129 | 1,0 | 44,0 | 86,0 | 2,0 | 123 | 108 | 2,2 | 199 | 88,0 | 3,0 | 250 | 99,0 | - | - | - | - | - | - | - | - |
| | 1,1 | 32,0 | 102 | 2,1 | 108 | 119 | 2,5 | 174 | 110 | 3,2 | 225 | 120 | 1,0 | 0,7 | 890 | 298 | 6100 | - | - | - |
| | - | - | - | 2,2 | 95,0 | 130 | 2,8 | 146 | 133 | 3,5 | 205 | 141 | 1,7 | 1,5 | 990 | 349 | 7000 | - | - | - |
| | - | - | - | 2,4 | 79,0 | 143 | 3,1 | 121 | 154 | 3,8 | 182 | 163 | 2,4 | 2,0 | 1040 | 385 | 7600 | - | - | - |
| | - | - | - | 2,5 | 64,0 | 155 | 3,2 | 108 | 166 | 4,1 | 159 | 184 | 3,1 | 3,0 | 1070 | 396 | 7900 | - | - | - |
| Ln XMW 5005 | - | - | - | 2,7 | 52,0 | 166 | 3,4 | 95 | 176 | 4,6 | 121 | 225 | 3,8 | 4,0 | 1170 | 455 | 9100 | - | - | - |
| An XMW 4004 | - | - | - | 2,8 | 42,0 | 178 | 3,5 | 84 | 187 | 4,9 | 93,0 | 255 | - | - | - | - | - | - | - | - |

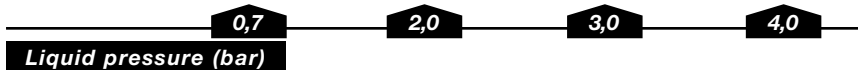

1/4" SIZE

PRESSURE PRINCIPLE

WIDE ANGLE FULL CONE SPRAY

Multiple orifice set-ups shown in this page can produce wider angle atomized sprays, as a result from the combination of several standard round sprays.

The resulting encompassed angle of the spray is approximately 60 degrees, more precise indications are given in the jet dimensions table on the right of the page.

Jet length can reach between 1.500 and 10.400 mm according to set-up size and operating conditions.

See advice on adjustment for flow rates and droplet size on page 8.

- Materials**
- T8 Nickel plated brass
 - B1 AISI 303 stainless steel
 - B3 AISI 316 stainless steel
 - D1 PVC

INTERNAL MIX SET-UPS

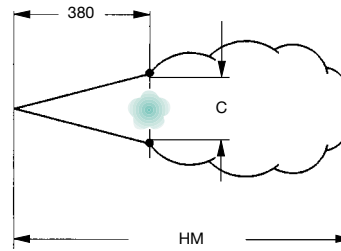

L = Water capacity (lph)
A = Air capacity (N-lpm)

| Set-up Code | Air pressure (bar) | | | | | | | | | | | | | | | | | | | |
|-----------------|--------------------|------|------|------|------|-------|-------|------|------|------|------|------|------|-----|-----|-------|------|----|--|--|
| | 0,7 | | 1,5 | | 2,0 | | 2,5 | | 3,0 | | 3,5 | | 4,0 | | PA | PL | C | HM | | |
| | L | A | L | A | L | A | L | A | L | A | L | A | L | A | | | | | | |
| SUL 1640 | 0,6 | 5,3 | 10,2 | 1,5 | 8,1 | 16,4 | 2,4 | 8,9 | 22,0 | 3,1 | 10,5 | 24,0 | 0,7 | 0,7 | 230 | 1500 | | | | |
| | 0,7 | 4,3 | 12,2 | 1,8 | 6,6 | 21,0 | 2,7 | 8,1 | 26,0 | 3,4 | 9,7 | 28,0 | 1,4 | 1,5 | 240 | 1800 | | | | |
| | 0,9 | 3,0 | 14,2 | 2,1 | 4,9 | 25,0 | 3,0 | 6,4 | 30,0 | 3,9 | 7,8 | 36,0 | 1,8 | 2,0 | 250 | 2100 | | | | |
| | 1,0 | 1,7 | 17,0 | 2,4 | 3,2 | 29,0 | 3,2 | 4,9 | 34,0 | 4,2 | 6,1 | 42,0 | 3,0 | 3,0 | 260 | 2700 | | | | |
| | Ln XMW 5001 | - | - | - | - | - | - | 3,4 | 4,2 | 37,0 | 4,6 | 4,4 | 47,0 | 3,9 | 4,0 | 300 | 4000 | | | |
| An XMW 4010 | - | - | - | - | - | - | 3,5 | 3,4 | 40,0 | 4,9 | 2,8 | 54,0 | - | - | - | - | | | | |
| SUM 2220 | 0,9 | 7,0 | 50,0 | 2,0 | 18,5 | 68,0 | 2,8 | 25,0 | 84,0 | 3,7 | 31,0 | 96,0 | - | - | - | - | | | | |
| | 1,0 | 2,1 | 62,0 | 2,1 | 15,1 | 76,0 | 3,0 | 22,0 | 92,0 | 3,8 | 28,0 | 105 | 0,9 | 0,7 | 310 | 1800 | | | | |
| | - | - | - | 2,2 | 11,7 | 85,0 | 3,1 | 18,5 | 101 | 3,9 | 26,0 | 113 | 1,7 | 1,5 | 330 | 2400 | | | | |
| | - | - | - | - | - | - | 3,2 | 15,1 | 109 | 4,1 | 23,0 | 122 | 2,1 | 2,0 | 330 | 3200 | | | | |
| | Ln XMW 5003 | - | - | - | - | - | - | 3,4 | 12,1 | 119 | 4,2 | 20,0 | 130 | 3,2 | 3,0 | 340 | 4100 | | | |
| An XMW 4011 | - | - | - | - | - | - | 3,5 | 9,1 | 130 | 4,6 | 13,6 | 153 | 4,1 | 4,0 | 370 | 5900 | | | | |
| - | - | - | - | - | - | - | 3,7 | 6,1 | 142 | 4,9 | 6,8 | 183 | - | - | - | - | | | | |
| SUL 2330 | 1,1 | 12,3 | 40,0 | 2,7 | 21,0 | 69,0 | 4,2 | 19,3 | 100 | 5,6 | 22,0 | 130 | - | - | - | - | | | | |
| | 1,3 | 9,9 | 45,0 | 3,0 | 16,3 | 78,0 | 4,6 | 14,6 | 113 | 6,0 | 17,6 | 142 | 1,5 | 0,7 | 230 | 2700 | | | | |
| | 1,4 | 7,9 | 50,0 | 3,2 | 12,3 | 86,0 | 4,9 | 10,8 | 124 | 6,3 | 14,0 | 152 | 3,0 | 1,5 | 240 | 4600 | | | | |
| | 1,5 | 6,1 | 54,0 | 3,4 | 10,7 | 91,0 | 5,3 | 8,1 | 135 | 6,7 | 11,4 | 163 | 3,4 | 2,0 | 240 | 5500 | | | | |
| | 1,7 | 4,9 | 58,0 | 3,5 | 9,3 | 94,0 | 5,6 | 6,2 | 146 | 7,0 | 9,1 | 174 | 5,3 | 3,0 | 250 | 7300 | | | | |
| | 1,8 | 3,9 | 62,0 | 3,9 | 6,4 | 105,0 | 6,0 | 4,9 | 157 | - | - | - | 6,3 | 4,0 | 300 | 9400 | | | | |
| | An XMW 4013 | 2,0 | 3,1 | 67,0 | 4,2 | 4,7 | 115,0 | 6,3 | 4,0 | 167 | - | - | - | - | - | - | - | | | |
| SUM 2460 | 0,7 | 24,0 | 32,0 | 2,1 | 33,0 | 66,0 | 2,8 | 52,0 | 65,0 | 3,7 | 63,0 | 68,0 | - | - | - | - | | | | |
| | 0,9 | 13,6 | 44,0 | 2,2 | 26,0 | 78,0 | 3,0 | 46,0 | 76,0 | 3,8 | 58,0 | 79,0 | 0,9 | 0,7 | 360 | 2100 | | | | |
| | 1,0 | 7,6 | 57,0 | 2,4 | 18,9 | 89,0 | 3,1 | 39,0 | 87,0 | 3,9 | 52,0 | 101 | 1,5 | 1,5 | 370 | 3200 | | | | |
| | - | - | - | 2,5 | 11,7 | 100 | 3,2 | 33,0 | 99,0 | 4,2 | 41,0 | 111 | 2,4 | 2,0 | 370 | 4100 | | | | |
| | Ln XMW 5004 | - | - | - | - | - | - | 3,4 | 26,0 | 110 | 4,6 | 27,0 | 138 | 3,2 | 3,0 | 380 | 5000 | | | |
| An XMW 4011 | - | - | - | - | - | - | 3,5 | 19,5 | 122 | 4,9 | 15,9 | 166 | 3,9 | 4,0 | 390 | 6800 | | | | |
| - | - | - | - | - | - | - | 3,7 | 13,2 | 133 | - | - | - | - | - | - | - | | | | |
| SUM 2860 | 1,3 | 36,0 | 85,0 | 3,1 | 53,0 | 156 | 4,2 | 64,0 | 197 | 5,6 | 74,0 | 245 | - | - | - | - | | | | |
| | 1,5 | 29,0 | 102 | 3,2 | 50,0 | 163 | 4,9 | 51,0 | 230 | 6,0 | 68,0 | 260 | 2,0 | 0,7 | 330 | 5500 | | | | |
| | 1,8 | 23,0 | 117 | 3,4 | 47,0 | 170 | 5,6 | 40,0 | 265 | 6,3 | 62,0 | 280 | 3,0 | 1,5 | 340 | 6400 | | | | |
| | 2,0 | 19,7 | 125 | 3,5 | 45,0 | 177 | 6,0 | 34,0 | 285 | 6,7 | 56,0 | 295 | 3,9 | 2,0 | 370 | 8200 | | | | |
| | 2,1 | 16,7 | 133 | 3,9 | 38,0 | 194 | 6,3 | 28,0 | 300 | 7,0 | 51,0 | 315 | 6,0 | 3,0 | 380 | 9100 | | | | |
| | 2,3 | 14,0 | 142 | 4,6 | 25,0 | 230 | 6,7 | 22,0 | 320 | - | - | - | 6,3 | 4,0 | 410 | 10400 | | | | |
| | An XMW 4012 | 2,4 | 11,4 | 149 | 4,9 | 18,5 | 245 | 7,0 | 17,8 | 335 | - | - | - | - | - | - | - | | | |
| SUQ 3140 | 1,7 | 25,0 | 156 | 3,4 | 50,0 | 250 | 4,6 | 62,0 | 320 | 6,0 | 93,0 | 395 | 2,0 | 0,7 | 460 | 5500 | | | | |
| | 1,8 | 19,7 | 167 | 3,5 | 43,0 | 260 | 4,9 | 47,0 | 345 | 6,3 | 77,0 | 425 | 3,2 | 1,5 | 470 | 6400 | | | | |
| | 2,0 | 15,1 | 178 | 3,7 | 41,0 | 275 | 5,3 | 36,0 | 375 | 6,7 | 62,0 | 460 | 3,9 | 2,0 | 510 | 7300 | | | | |
| | 2,1 | 11,4 | 193 | 3,9 | 27,0 | 300 | 5,6 | 26,0 | 405 | 7,0 | 52,0 | 495 | 5,3 | 3,0 | 530 | 7900 | | | | |
| | 2,3 | 7,6 | 205 | 4,1 | 23,0 | 310 | 6,0 | 18,9 | 435 | - | - | - | 6,3 | 4,0 | 580 | 9800 | | | | |
| | Ln XMW 5005 | - | - | - | 4,2 | 18,9 | 320 | 6,3 | 13,6 | 460 | - | - | - | - | - | - | - | | | |
| An XMW 4014 | - | - | - | 4,4 | 15,9 | 335 | - | - | - | - | - | - | - | - | - | - | | | | |

0,7

2,0

3,0

4,0

Liquid pressure (bar)

PRESSURE PRINCIPLE

1/4" SIZE

INTERNAL MIX SET-UPS

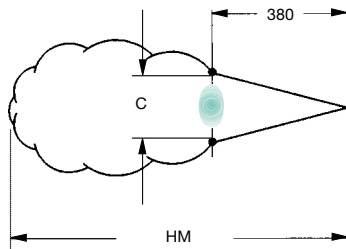

L = Water capacity (lph)
 A = Air capacity (N-lpm)

FLAT SPRAY

Flat fan shape atomized sprays can be produced with the set-ups listed in this page.

Precise dimensions of the atomized jet for each set-up can be obtained from the table on the right.

Jet length can reach between 1.800 and 5.200 mm, according to set-up size and operating conditions.

See advice on adjustment for flow rates and droplet size at page 8.

Materials T8 Nickel plated brass
 B1 AISI 303 stainless steel
 B3 AISI 316 stainless steel
 D1 PVC

| Set-up Code | Air pressure (bar) | | | | | | | | | | | | | | | | |
|-----------------|----------------------------|------|------|-----|------|------|-----|------|------|-----|------|------|-----|-----|-----|------|------|
| | 0,7 | | 2,0 | | 3,0 | | 4,0 | | PA | PL | C | HM | | | | | |
| | L | A | L | A | L | A | L | A | | | | | | | | | |
| SUU 2101 | 0,7 | 5,5 | 24 | 2,0 | 8,6 | 42 | 2,7 | 11,2 | 52 | 3,9 | 12 | 69 | 1,1 | 0,7 | 460 | 2600 | |
| | 0,9 | 4,7 | 27 | 2,2 | 7,5 | 47 | 3,0 | 10,1 | 56 | 4,6 | 9,7 | 81 | 2,1 | 1,5 | 660 | 3000 | |
| | 1,0 | 4,1 | 31 | 2,5 | 6,2 | 52 | 3,2 | 9,1 | 62 | 5,3 | 7,5 | 93 | 2,8 | 2,0 | 760 | 3200 | |
| | 1,1 | 3,5 | 34 | 2,8 | 5,2 | 57 | 3,5 | 8,1 | 66 | 6,0 | 5,3 | 104 | 3,5 | 3,0 | 860 | 3400 | |
| | 1,3 | 3,0 | 37 | 3,1 | 4,2 | 63 | 4,2 | 5,4 | 79 | 6,3 | 4,3 | 110 | 6,0 | 4,0 | 940 | 4000 | |
| | Ln XMW 5001 An XMW 4020 | 1,4 | 2,5 | 40 | 3,2 | 3,7 | 65 | 4,6 | 4,2 | 85 | 6,7 | 3,3 | 116 | - | - | - | - |
| | 1,5 | 2,0 | 44 | 3,4 | 3,2 | 68 | 4,9 | 3,1 | 91 | 7,0 | 2,4 | 122 | - | - | - | - | |
| SUU 2160 | 1,3 | 3,9 | 30 | 3,0 | 6,1 | 52 | 3,9 | 9,4 | 60 | 5,3 | 10,2 | 78 | 1,5 | 0,7 | 460 | 1800 | |
| | 1,4 | 3,0 | 33 | 3,1 | 5,3 | 54 | 4,2 | 7,2 | 67 | 5,6 | 8,3 | 84 | 2,7 | 1,5 | 690 | 2000 | |
| | 1,5 | 2,3 | 35 | 3,2 | 4,5 | 57 | 4,6 | 5,3 | 73 | 6,0 | 6,6 | 89 | 3,2 | 2,0 | 910 | 2000 | |
| | 1,7 | 1,8 | 38 | 3,4 | 3,8 | 59 | 4,9 | 3,8 | 80 | 6,3 | 5,1 | 98 | 4,2 | 3,0 | 940 | 2100 | |
| | Ln XMW 5002 An XMW 4022 | 1,8 | 1,3 | 41 | 3,5 | 3,2 | 62 | - | - | - | - | - | - | 5,6 | 4,0 | 970 | 2300 |
| | | 2,0 | 1,0 | 44 | 3,9 | 1,8 | 68 | - | - | - | - | - | - | - | - | - | - |
| SUM 2167 | 1,0 | 9,0 | 25 | 2,4 | 11,6 | 48 | 3,1 | 15,6 | 56 | 4,2 | 17,1 | 73 | 1,4 | 0,7 | 170 | 3000 | |
| | 1,1 | 7,8 | 30 | 2,5 | 10,4 | 51 | 3,2 | 14,6 | 59 | 4,6 | 15 | 80 | 2,5 | 1,5 | 200 | 3700 | |
| | 1,3 | 6,6 | 32 | 2,7 | 9,40 | 54 | 3,4 | 13,7 | 62 | 4,9 | 12,8 | 87 | 3,2 | 2,0 | 220 | 4000 | |
| | 1,4 | 5,2 | 36 | 3,0 | 7,30 | 61 | 3,8 | 10,8 | 71 | 5,3 | 11 | 94 | 3,8 | 3,0 | 280 | 4200 | |
| | Ln XMW 5002 An XMW 4021 | 1,7 | 3,1 | 44 | 3,2 | 5,50 | 68 | 4,2 | 8,5 | 82 | 5,6 | 9,4 | 103 | 5,3 | 4,0 | 330 | 4800 |
| | | 2,0 | 2,0 | 50 | 3,5 | 4,10 | 75 | 4,9 | 5,2 | 98 | 6,3 | 7,2 | 119 | - | - | - | - |
| | 2,2 | 1,1 | 56 | 3,8 | 2,90 | 81 | 6,0 | 2,3 | 120 | 7,0 | 6,1 | 134 | - | - | - | - | |
| SUU 2171 | 0,9 | 8,2 | 20 | 2,1 | 13,5 | 36 | 2,7 | 19,1 | 42 | 4,6 | 16,1 | 69 | 1,1 | 0,7 | 710 | 2100 | |
| | 1,0 | 6,8 | 23 | 2,4 | 11,4 | 42 | 3,0 | 17,1 | 46 | 4,9 | 13,8 | 76 | 2,1 | 1,5 | 810 | 2400 | |
| | 1,1 | 5,5 | 27 | 2,7 | 9,20 | 47 | 3,2 | 15,1 | 52 | 5,3 | 11,5 | 83 | 3,0 | 2,0 | 890 | 2600 | |
| | 1,3 | 4,1 | 30 | 3,0 | 7,10 | 53 | 3,5 | 13,1 | 57 | 5,6 | 9,3 | 90 | 3,5 | 3,0 | 970 | 2700 | |
| | Ln XMW 5002 An XMW 4020 | 1,4 | 2,9 | 34 | 3,2 | 5,00 | 59 | 4,2 | 8,1 | 72 | 6,0 | 7,3 | 97 | 5,6 | 4,0 | 970 | 3200 |
| | | - | - | - | 3,4 | 4,00 | 63 | 4,6 | 5,9 | 79 | 6,3 | 5,6 | 104 | - | - | - | - |
| | - | - | - | 3,5 | 3,30 | 66 | 4,9 | 4,0 | 86 | 6,7 | 4,3 | 112 | - | - | - | - | |
| SUM 2320 | 1,1 | 11,2 | 54 | 2,7 | 19,6 | 93 | 3,5 | 27 | 112 | 4,6 | 33 | 137 | 1,4 | 0,7 | 200 | 3000 | |
| | 1,3 | 8,5 | 60 | 2,8 | 17,3 | 98 | 3,7 | 25 | 116 | 4,9 | 28 | 149 | 2,4 | 1,5 | 330 | 3200 | |
| | 1,4 | 6,5 | 65 | 3,0 | 15,2 | 103 | 3,8 | 23 | 121 | 5,3 | 24 | 161 | 3,0 | 2,0 | 460 | 3400 | |
| | 1,5 | 5,0 | 71 | 3,1 | 13,2 | 109 | 3,9 | 21 | 126 | 5,6 | 19,7 | 174 | 3,7 | 3,0 | 460 | 3500 | |
| | Ln XMW 5003 An XMW 4024 | 1,7 | 3,8 | 77 | 3,2 | 11,4 | 114 | 4,1 | 18,9 | 132 | 6,0 | 15,7 | 187 | 5,3 | 4,0 | 480 | 4000 |
| | | - | - | - | - | - | - | 4,2 | 17 | 137 | 6,3 | 12,4 | 200 | - | - | - | - |
| SUM 2600 | 1,0 | 17,0 | 23 | 2,4 | 28,0 | 51 | 3,4 | 38 | 72 | 3,9 | 65 | 75 | 1,1 | 0,7 | 150 | 2400 | |
| | 1,1 | 11,0 | 27 | 2,5 | 23,0 | 59 | 3,5 | 33 | 80 | 4,2 | 53 | 89 | 2,1 | 1,5 | 170 | 3000 | |
| | 1,3 | 7,6 | 33 | 2,7 | 18,9 | 66 | 3,7 | 28 | 89 | 4,6 | 40 | 108 | 2,8 | 2,0 | 220 | 3400 | |
| | 1,4 | 3,2 | 40 | 2,8 | 15,1 | 74 | 3,8 | 23 | 97 | 4,9 | 30 | 127 | 3,7 | 3,0 | 280 | 3600 | |
| | Ln XMW 5004 An XMW 4023 | - | - | - | 3,0 | 11,7 | 79 | 3,9 | 19,7 | 105 | 5,3 | 21 | 149 | 4,9 | 4,0 | 350 | 4000 |
| | | - | - | - | - | - | - | 4,2 | 13,1 | 120 | 5,6 | 13,8 | 173 | - | - | - | - |
| | - | - | - | - | - | - | 4,6 | 7,2 | 138 | 6,3 | 3,2 | 225 | - | - | - | - | |
| SUQ 2700 | 0,9 | 27,0 | 33 | 2,4 | 39,0 | 67 | 3,2 | 58 | 76 | 4,6 | 59 | 106 | 1,1 | 0,7 | 300 | 3400 | |
| | 1,0 | 20,0 | 38 | 2,7 | 30,0 | 77 | 3,5 | 47 | 87 | 5,3 | 40 | 132 | 2,4 | 1,5 | 410 | 3500 | |
| | 1,1 | 15,9 | 45 | 3,0 | 24,0 | 87 | 3,8 | 38 | 97 | 5,6 | 32 | 145 | 3,2 | 2,0 | 430 | 3700 | |
| | 1,3 | 12,5 | 48 | 3,2 | 17,8 | 98 | 3,9 | 34 | 103 | 6,0 | 26 | 158 | 3,9 | 3,0 | 480 | 3800 | |
| | Ln XMW 5004 An XMW 4024 | 1,4 | 10,2 | 56 | 3,4 | 15,1 | 103 | 4,2 | 27 | 113 | 6,3 | 20 | 172 | 6,0 | 4,0 | 510 | 4400 |
| | | 1,5 | 7,6 | 62 | 3,5 | 12,9 | 109 | 4,6 | 20 | 126 | 6,7 | 15,9 | 185 | - | - | - | - |
| | - | - | - | 3,7 | 10,6 | 114 | 4,9 | 14,8 | 140 | 7,0 | 12,7 | 198 | - | - | - | - | |
| SUQ 3126 | 1,0 | 29,0 | 90 | 2,1 | 100 | 119 | 3,0 | 126 | 140 | 4,1 | 140 | 181 | 1,0 | 0,7 | 250 | 3400 | |
| | 1,1 | 18,9 | 108 | 2,2 | 79,0 | 133 | 3,1 | 110 | 151 | 4,2 | 125 | 193 | 1,8 | 1,5 | 430 | 3800 | |
| | - | - | - | 2,4 | 62,0 | 147 | 3,2 | 95 | 163 | 4,6 | 89 | 225 | 2,4 | 2,0 | 460 | 4300 | |
| | - | - | - | 2,5 | 48,0 | 162 | 3,4 | 78 | 184 | 4,9 | 58 | 265 | 3,4 | 3,0 | 530 | 4600 | |
| | Ln XMW 5005 An XMW 4025 | - | - | - | 2,7 | 36,0 | 177 | 3,5 | 62 | 193 | 5,3 | 34 | 305 | 4,9 | 4,0 | 580 | 5200 |
| | | - | - | - | - | - | - | 3,7 | 48 | 210 | 5,6 | 16,7 | 340 | - | - | - | - |
| | - | - | - | - | - | - | 3,8 | 37 | 225 | - | - | - | - | - | - | - | |

0,7

2,0

3,0

4,0

Liquid pressure (bar)

1/4" SIZE

SYPHON PRINCIPLE

ROUND AND FLAT SPRAY

These set-ups are designed to work with water fed from an ambient pressure reservoir, either by liquid syphon aspiration or by gravity head. The flow rate tables therefore give the liquid flow rate for both suction head (green field) and gravity head (white field).

Approximate jet dimensions are given in the table on the right and advice on adjustment for flow rates and droplet size at page 8.

- Materials T8 Nickel plated brass
- B1 AISI 303 stainless steel
- B3 AISI 316 stainless steel
- D1 PVC

INTERNAL MIX SET-UPS

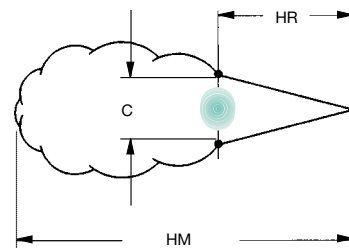

L = Water capacity (lph)
A = Air capacity (N-lpm)



| Set-up Code | Air pressure (bar) | | | | | | | | | | Full cone spray | | | |
|-----------------|----------------------|-----|------|------|------|------|------|------|------|-----|-----------------|-----|-----|------|
| | Air capacity (N-lpm) | | | | | | | | | | PA | HR | C | HM |
| | Water capacity (lph) | | | | | | | | | | | | | |
| SUC 1120 | 0,7 | 11 | 1,5 | 1,3 | 1,1 | 0,9 | 0,7 | 0,5 | - | - | 0,7 | 280 | 89 | 1800 |
| Ln XMW 5006 | 1,5 | 17 | 1,8 | 1,7 | 1,5 | 1,3 | 1,2 | 1,1 | 0,6 | - | 1,5 | 280 | 89 | 1900 |
| An XMW 4040 | 3,0 | 28 | 2,1 | 1,9 | 1,7 | 1,5 | 1,4 | 1,3 | 1,1 | 0,8 | 3,0 | 300 | 95 | 2300 |
| | 4,0 | 36 | 2,2 | 2,0 | 1,8 | 1,6 | 1,5 | 1,4 | 1,2 | 0,9 | 4,0 | 360 | 114 | 2600 |
| SUC 1190 | 0,7 | 13 | 2,4 | 2,1 | 1,7 | 1,5 | 1,2 | 0,8 | - | - | 0,7 | 300 | 95 | 2100 |
| Ln XMW 5001 | 1,5 | 20 | 2,8 | 2,6 | 2,4 | 2,1 | 1,9 | 1,6 | 0,9 | - | 1,5 | 330 | 104 | 2300 |
| An XMW 4040 | 3,0 | 32 | 3,4 | 3,1 | 2,9 | 2,8 | 2,6 | 2,4 | 1,7 | 1,1 | 3,0 | 380 | 120 | 2600 |
| | 4,0 | 41 | 3,7 | 3,4 | 3,3 | 3,1 | 2,9 | 2,7 | 2,1 | 1,5 | 4,0 | 430 | 144 | 3000 |
| SUC 1200 | 0,7 | 23 | 2,5 | 2,3 | 2,0 | 1,6 | 1,4 | 1,1 | - | - | 0,7 | 300 | 95 | 2400 |
| Ln XMW 5001 | 1,5 | 36 | 2,9 | 2,8 | 2,5 | 2,2 | 2,0 | 1,7 | 0,9 | - | 1,5 | 330 | 104 | 2700 |
| An XMW 4041 | 3,0 | 58 | 3,4 | 3,3 | 3,2 | 2,9 | 2,8 | 2,5 | 1,9 | 1,2 | 3,0 | 380 | 127 | 3400 |
| | 4,0 | 74 | 3,7 | 3,6 | 3,5 | 3,4 | 3,3 | 3,0 | 2,5 | 2,0 | 4,0 | 430 | 151 | 4000 |
| SUC 1290 | 0,7 | 19 | 4,5 | 4,0 | 3,4 | 2,1 | 1,8 | 1,4 | - | - | 0,7 | 380 | 140 | 3000 |
| Ln XMW 5002 | 1,5 | 31 | 5,3 | 4,9 | 4,4 | 3,5 | 2,9 | 2,7 | 1,8 | - | 1,5 | 410 | 152 | 3400 |
| An XMW 4041 | 3,0 | 50 | 6,0 | 5,6 | 5,0 | 4,4 | 4,0 | 3,4 | 2,4 | 1,2 | 3,0 | 460 | 170 | 4000 |
| | 4,0 | 65 | 5,7 | 5,4 | 5,0 | 4,2 | 3,9 | 3,5 | 2,8 | 1,9 | 4,0 | 510 | 198 | 4600 |
| SUC 2105 | 1,5 | 58 | 22,0 | 19,9 | 16,3 | 12,3 | 10,5 | 8,3 | 2,8 | - | 1,5 | 460 | 137 | 3700 |
| Ln XMW 5004 | 3,0 | 88 | 25,0 | 23,0 | 19,5 | 16,7 | 14,2 | 11,5 | 6,4 | 2,8 | 3,0 | 510 | 161 | 4300 |
| An XMW 4042 | 4,0 | 111 | 26,0 | 24,0 | 21,0 | 18,4 | 15,7 | 12,9 | 7,9 | 4,5 | 4,0 | 530 | 168 | 4900 |
| | 5,6 | 147 | 26,0 | 24,0 | 22,0 | 19,7 | 17,0 | 14,6 | 9,8 | 6,1 | 5,6 | 580 | 194 | 5500 |
| SUC 2180 | 2,0 | 144 | - | - | - | 27,0 | 22,0 | 16,8 | - | - | 2,0 | 510 | 180 | 6700 |
| Ln XMW 5005 | 3,0 | 190 | - | - | - | 30,0 | 26,0 | 21,0 | - | - | 3,0 | 530 | 187 | 7000 |
| An XMW 4043 | 4,0 | 240 | - | 43,0 | 40,0 | 31,0 | 28,0 | 23,0 | 11,0 | - | 4,0 | 580 | 215 | 7600 |
| | 5,6 | 315 | 44,0 | 42,0 | 39,0 | 31,0 | 28,0 | 24,0 | 16,7 | 8,3 | 5,6 | 630 | 245 | 8200 |

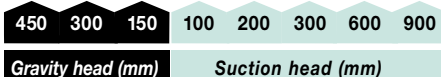

| Set-up Code | Air pressure (bar) | | | | | | | | | | Flat spray | | |
|-----------------|----------------------|-----|-----|-----|-----|-----|-----|-----|-----|-----|------------|-----|------|
| | Air capacity (N-lpm) | | | | | | | | | | PA | C | HM |
| | Water capacity (lph) | | | | | | | | | | | | |
| SUQ 0860 | 0,7 | 28 | 1,3 | 1,2 | 1,1 | 1,0 | 1,0 | 0,8 | 0,6 | 0,5 | 0,7 | 380 | 2100 |
| Ln XMW 5002 | 1,5 | 43 | 1,2 | 1,1 | 1,0 | 0,9 | 0,9 | 0,8 | 0,7 | 0,5 | 1,5 | 380 | 2100 |
| An XMW 4026 | 2,0 | 50 | 0,8 | 0,8 | 0,7 | 0,6 | 0,5 | - | - | - | 2,0 | 380 | 1800 |
| SUQ 1280 | 1,5 | 56 | 3,7 | 3,5 | 3,3 | 2,9 | 2,8 | 2,5 | 2,3 | 2,1 | 1,5 | 380 | 2700 |
| Ln XMW 5007 | 2,0 | 65 | 3,4 | 3,3 | 3,1 | 2,8 | 2,7 | 2,6 | 2,4 | 2,2 | 2,0 | 420 | 2700 |
| An XMW 4027 | 3,0 | 87 | 2,8 | 2,7 | 2,5 | 2,4 | 2,2 | 2,1 | 1,9 | 1,7 | 3,0 | 460 | 3000 |
| | 4,0 | 110 | 1,9 | 1,8 | 1,6 | 1,5 | 1,3 | 1,2 | - | - | 4,0 | 480 | 2700 |
| SUQ 1370 | 1,5 | 68 | 5,1 | 4,8 | 4,5 | 3,8 | 3,7 | 3,5 | 3,0 | 2,4 | 1,5 | 270 | 3400 |
| Ln XMW 5003 | 2,0 | 78 | 4,9 | 4,7 | 4,4 | 3,6 | 3,4 | 3,2 | 2,9 | 2,3 | 2,0 | 280 | 3400 |
| An XMW 4028 | 3,0 | 103 | 3,4 | 3,2 | 3,0 | 2,2 | 2,0 | 1,7 | - | - | 3,0 | 300 | 3000 |
| | 3,5 | 117 | 2,2 | 2,0 | 1,7 | - | - | - | - | - | - | - | - |
| SUQ 1540 | 1,5 | 63 | 7,6 | 7,2 | 6,6 | 5,7 | 5,4 | 5,1 | 4,6 | 3,7 | 1,5 | 270 | 3400 |
| Ln XMW 5003 | 2,0 | 73 | 7,6 | 7,3 | 6,8 | 5,9 | 5,7 | 5,5 | 5,0 | 4,2 | 2,0 | 290 | 3400 |
| An XMW 4029 | 3,0 | 96 | 6,4 | 6,1 | 5,7 | 5,0 | 4,5 | 4,1 | 3,3 | - | 3,0 | 330 | 3400 |
| | 3,5 | 110 | 4,2 | 3,7 | 3,2 | 2,6 | - | - | - | - | - | - | - |

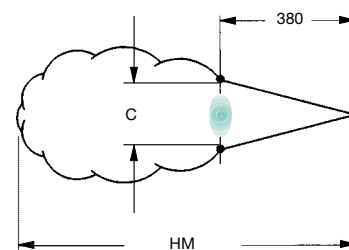
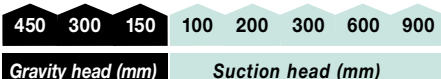

L = Water capacity (lph)
A = Air capacity (N-lpm)



EXTERNAL MIX SET-UPS

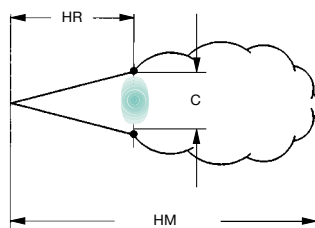
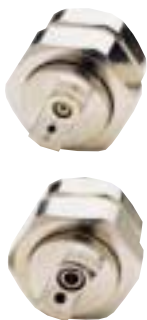

L = Water capacity (lph)
A = Air capacity (N-lpm)

FLAT SPRAY

These set-ups are designed so that liquid and air are ejected from different orifices and impact outside the nozzle, producing the atomized spray.

They are therefore recommended for atomizing viscous liquids. Approximate jet dimensions, depending upon set-up size and operating conditions are shown on the right. Detailed information can be found on page 8.

Materials
T8 Nickel plated brass
B1 AISI 303 stainless steel
B3 AISI 316 stainless steel

| Set-up Code | Air pressure (bar) | | | | | | | | | | | | | | | | | | | |
|-----------------|----------------------------|------|-----|-----|------|-----|-----|------|-----|-----|------|-----|-----|------|-----|-----|-----|-----|------|------|
| | L | | A | | L | | A | | L | | A | | L | | A | | PA | PL | C | HM |
| SUL 2110 | 0,2 | | 25 | 0,4 | | 26 | 0,7 | | 31 | 1,4 | | 45 | 2,8 | | 74 | 0,2 | 0,2 | 230 | 900 | 150 |
| | 0,4 | | 26 | 0,7 | | 31 | 1,1 | | 40 | 1,8 | | 54 | 3,5 | | 85 | 1,1 | 0,2 | 230 | 1200 | 150 |
| | 0,7 | | 31 | 1,1 | | 40 | 1,4 | | 45 | 2,1 | | 60 | 4,2 | | 102 | 1,4 | 0,4 | 230 | 1200 | 150 |
| | 1,1 | 2,8 | 40 | 1,4 | 3,5 | 45 | 1,8 | 5,3 | 54 | 2,8 | 7,8 | 74 | 4,9 | 11 | 119 | 1,4 | 1,4 | 250 | 1500 | 180 |
| | 1,4 | | 45 | 1,8 | | 54 | 2,1 | | 59 | 3,5 | | 85 | 5,3 | | 128 | 1,8 | 0,7 | 240 | 1500 | 150 |
| | Ln XMW 5006 An XMW 4030 | 1,8 | | 54 | 2,1 | | 59 | 2,8 | | 74 | 4,2 | | 102 | 5,6 | | 139 | 2,8 | 1,4 | 280 | 1800 |
| | 2,1 | | 59 | 2,8 | | 74 | 3,5 | | 85 | 5,6 | | 139 | 6,3 | | 159 | 4,9 | 2,8 | 240 | 2400 | 180 |
| SUT 2111 | 0,4 | | 22 | 0,4 | | 22 | 0,4 | | 25 | 0,6 | | 34 | 0,7 | | 34 | 0,6 | 0,7 | 400 | 1800 | 300 |
| | 0,5 | 2,8 | 25 | 0,5 | 3,5 | 25 | 0,6 | 5,3 | 28 | 0,7 | 7,8 | 34 | 1,1 | 11 | 45 | 0,6 | 1,5 | 460 | 1800 | 350 |
| | 0,5 | | 27 | 0,6 | | 28 | 0,7 | | 34 | 1,1 | | 45 | 1,8 | | 62 | 1,4 | 1,5 | 410 | 2700 | 300 |
| | 0,6 | | 28 | 0,7 | | 34 | 0,9 | | 40 | 1,4 | | 54 | 2,5 | | 79 | 1,1 | 2,0 | 480 | 2600 | 350 |
| SUR 2166 | 0,4 | | 26 | 0,7 | | 31 | 1,1 | | 40 | 1,8 | | 54 | 3,2 | | 82 | 0,4 | 0,2 | 220 | 1000 | 140 |
| | 0,7 | | 31 | 1,1 | | 40 | 1,4 | | 45 | 2,1 | | 59 | 3,5 | | 85 | 1,4 | 0,2 | 220 | 1700 | 150 |
| | 1,1 | | 40 | 1,4 | | 45 | 1,8 | | 54 | 2,8 | | 74 | 4,2 | | 102 | 1,8 | 0,4 | 230 | 1800 | 165 |
| | 1,4 | 4,5 | 45 | 1,8 | 5,5 | 54 | 2,1 | 8,3 | 59 | 3,5 | 12,2 | 85 | 4,9 | 16,6 | 119 | 1,8 | 1,4 | 290 | 2100 | 190 |
| | 1,8 | | 54 | 2,1 | | 59 | 2,8 | | 74 | 4,2 | | 102 | 5,3 | | 127 | 2,1 | 0,7 | 250 | 1800 | 180 |
| | Ln XMW 5001 An XMW 4030 | 2,1 | | 59 | 2,8 | | 74 | 3,5 | | 85 | 4,9 | | 119 | 6,3 | | 159 | 3,5 | 1,4 | 300 | 2400 |
| | 2,8 | | 74 | 3,5 | | 85 | 4,2 | | 102 | 6,3 | | 159 | 6,7 | | 164 | 5,3 | 2,8 | 250 | 3000 | 190 |
| SUV 2172 | 0,4 | | 22 | 0,4 | | 22 | 0,6 | | 28 | 0,7 | | 34 | 1,1 | | 34 | 0,7 | 1,5 | 580 | 1800 | 460 |
| | 0,6 | 4,5 | 28 | 0,7 | 5,5 | 34 | 0,7 | 8,3 | 34 | 1,4 | 12,2 | 54 | 1,4 | 17,2 | 54 | 1,4 | 1,5 | 560 | 2400 | 430 |
| | 0,7 | | 34 | 1,1 | | 45 | 1,4 | | 54 | 2,1 | | 71 | 2,1 | | 71 | 1,8 | 2,0 | 580 | 2700 | 460 |
| | 1,1 | | 45 | 1,4 | | 54 | 2,1 | | 71 | 2,5 | | 79 | 2,5 | | 79 | 1,8 | 3,0 | 660 | 2900 | 480 |
| SUS 2330 | 0,7 | | 31 | 1,1 | | 40 | 1,4 | | 45 | 2,5 | | 68 | 3,5 | | 85 | 0,7 | 0,2 | 250 | 1200 | 165 |
| | 1,1 | | 40 | 1,4 | | 45 | 1,8 | | 54 | 2,8 | | 74 | 4,2 | | 102 | 1,8 | 0,2 | 250 | 1800 | 165 |
| | 1,4 | | 45 | 1,8 | | 54 | 2,1 | | 59 | 3,5 | | 85 | 4,9 | | 119 | 2,1 | 0,4 | 240 | 1800 | 180 |
| | 1,8 | 8,5 | 54 | 2,1 | 10,4 | 59 | 2,8 | 15,9 | 74 | 4,2 | 23 | 102 | 5,3 | 33 | 127 | 2,5 | 1,4 | 320 | 1800 | 200 |
| | 2,1 | | 59 | 2,8 | | 74 | 3,5 | | 85 | 4,9 | | 119 | 5,6 | | 139 | 2,8 | 0,7 | 300 | 2300 | 190 |
| | Ln XMW 5002 An XMW 4030 | 2,8 | | 74 | 3,5 | | 85 | 4,2 | | 102 | 5,6 | | 139 | 6,3 | | 159 | 4,2 | 1,4 | 360 | 3000 |
| | 3,5 | | 85 | 4,2 | | 102 | 4,9 | | 119 | 6,3 | | 159 | 7,0 | | 176 | 5,3 | 2,8 | 300 | 4000 | 200 |
| SUV 2331 | 0,4 | | 25 | 0,4 | | 25 | 0,4 | | 25 | 0,7 | | 34 | 1,4 | | 34 | 0,6 | 0,7 | 630 | 1500 | 480 |
| | 0,5 | 8,5 | 27 | 0,6 | 10,4 | 28 | 0,6 | 15,9 | 28 | 0,9 | 23 | 40 | 1,8 | 33 | 62 | 0,7 | 1,5 | 630 | 1800 | 480 |
| | 0,6 | | 28 | 0,7 | | 31 | 0,7 | | 34 | 1,1 | | 45 | 2,1 | | 45 | 1,4 | 1,5 | 660 | 2400 | 530 |
| | 0,7 | | 34 | 0,8 | | 34 | 0,9 | | 40 | 1,4 | | 54 | 2,5 | | 54 | 1,8 | 2,0 | 690 | 2700 | 510 |
| SUQ 2520 | 0,7 | | 85 | 1,0 | | 102 | 1,4 | | 116 | 2,5 | | 178 | 3,2 | | 212 | 0,7 | 0,2 | 250 | 1700 | 190 |
| | 1,0 | | 102 | 1,4 | | 116 | 1,8 | | 139 | 2,8 | | 195 | 3,5 | | 232 | 1,8 | 0,2 | 250 | 2700 | 190 |
| | 1,4 | | 116 | 1,8 | | 139 | 2,1 | | 156 | 3,5 | | 227 | 3,9 | | 255 | 2,1 | 0,4 | 280 | 3000 | 190 |
| | 1,8 | 13,4 | 139 | 2,1 | 16,4 | 156 | 2,5 | 25 | 178 | 4,2 | 37 | 266 | 4,2 | 52 | 275 | 2,5 | 0,7 | 280 | 3500 | 220 |
| | 2,1 | | 156 | 2,8 | | 195 | 2,8 | | 195 | 4,9 | | 312 | 4,9 | | 314 | 2,5 | 1,4 | 360 | 3700 | 230 |
| | Ln XMW 5007 An XMW 4032 | 2,8 | | 195 | 3,5 | | 227 | 3,5 | | 227 | 5,6 | | 360 | 5,6 | | 360 | 4,2 | 1,4 | 370 | 4300 |
| | 3,5 | | 227 | 4,2 | | 266 | 4,2 | | 266 | 6,3 | | 411 | 6,3 | | 411 | 4,9 | 2,8 | 320 | 4900 | 220 |
| SUV 2521 | 0,6 | | 91 | 0,7 | | 102 | 1,4 | | 156 | 2,1 | | 210 | 3,2 | | 285 | 2,1 | 0,7 | 560 | 4300 | 400 |
| | 0,7 | 13,4 | 102 | 1,1 | 16,4 | 130 | 2,1 | 25 | 210 | 2,8 | 37 | 260 | 4,2 | 52 | 360 | 2,1 | 1,5 | 580 | 4000 | 460 |
| | 1,1 | | 130 | 1,8 | | 184 | 2,5 | | 235 | 3,5 | | 310 | 5,3 | | 430 | 4,2 | 1,5 | 640 | 5200 | 480 |
| | 1,4 | | 156 | 2,1 | | 210 | 2,8 | | 260 | 4,2 | | 360 | 5,6 | | 455 | 3,9 | 2,0 | 690 | 4600 | 510 |

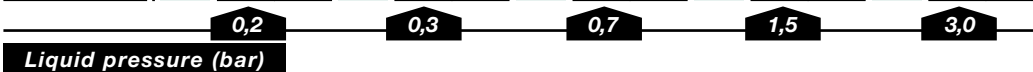

1/4" SIZE

PRESSURE PRINCIPLE

FLAT SPRAY

EXTERNAL MIX SET-UPS

| Set-up Code | Air pressure (bar) | | | | | | | | | | | | | | | | | | | | |
|-----------------|--------------------|------|-----|-----|-----|-----|-----|-----|-----|-----|-----|-----|-----|-----|-----|-----|-----|-----|------|-----|----|
| | L | | A | | L | | A | | L | | A | | L | | A | | PA | PL | C | HM | HR |
| SUT 2680 | 0,7 | | 85 | 1,4 | | 116 | 1,8 | | 139 | 2,8 | | 195 | 3,5 | | 232 | 0,7 | 0,4 | 270 | 2100 | 190 | |
| | 1,0 | | 102 | 1,8 | | 139 | 2,1 | | 156 | 3,2 | | 212 | 4,2 | | 275 | 1,8 | 0,7 | 270 | 3000 | 190 | |
| | 1,4 | | 116 | 2,1 | | 156 | 2,5 | | 178 | 3,5 | | 227 | 4,9 | | 314 | 2,5 | 1,4 | 330 | 3400 | 220 | |
| | 1,8 | 17,6 | 139 | 2,5 | 22 | 178 | 2,8 | 33 | 195 | 4,2 | 48 | 266 | 5,3 | 68 | 340 | 2,8 | 1,4 | 360 | 3800 | 220 | |
| | 2,1 | | 156 | 2,8 | | 195 | 3,5 | | 227 | 4,9 | | 312 | 5,6 | | 360 | 2,8 | 1,4 | 370 | 4000 | 250 | |
| Ln XMW 5003 | 2,8 | | 195 | 3,5 | | 227 | 4,2 | | 266 | 5,6 | | 360 | 6,3 | | 411 | 4,2 | 2,1 | 370 | 4900 | 250 | |
| An XMW 4032 | 3,5 | | 227 | 4,2 | | 266 | 4,9 | | 312 | 6,3 | | 411 | 6,6 | | 428 | 5,3 | 2,8 | 360 | 5800 | 230 | |
| SUV 2681 | 0,6 | | 91 | 0,7 | | 102 | 1,1 | | 130 | 2,5 | | 235 | 3,5 | | 310 | 1,8 | 0,7 | 640 | 3000 | 480 | |
| | 1,1 | 17,6 | 130 | 1,4 | 22 | 156 | 1,8 | 33 | 184 | 3,2 | 48 | 285 | 4,6 | 68 | 380 | 2,5 | 1,5 | 640 | 3800 | 460 | |
| | 1,4 | | 156 | 1,8 | | 184 | 2,5 | | 235 | 3,9 | | 330 | 6,0 | | 475 | 4,2 | 1,5 | 580 | 4900 | 430 | |
| | 1,8 | | 184 | 2,1 | | 210 | 2,8 | | 260 | 4,2 | | 360 | 6,7 | | 525 | 4,2 | 2,0 | 610 | 5200 | 430 | |
| SUN 3101 | 1,0 | | 102 | 1,8 | | 139 | 2,5 | | 178 | 3,2 | | 212 | 3,9 | | 255 | 1,0 | 0,2 | 250 | 2700 | 200 | |
| | 1,4 | | 116 | 2,1 | | 156 | 2,8 | | 195 | 3,5 | | 227 | 4,2 | | 275 | 2,1 | 0,2 | 290 | 3000 | 220 | |
| | 1,8 | | 139 | 2,5 | | 178 | 3,2 | | 212 | 3,9 | | 246 | 4,6 | | 297 | 2,8 | 0,4 | 360 | 3500 | 240 | |
| | 2,1 | 36 | 156 | 2,8 | 45 | 195 | 3,5 | 68 | 227 | 4,2 | 100 | 266 | 4,9 | 141 | 314 | 3,2 | 1,4 | 390 | 3700 | 280 | |
| | 2,5 | | 178 | 3,2 | | 212 | 4,2 | | 266 | 4,9 | | 312 | 5,6 | | 360 | 3,5 | 0,7 | 380 | 4000 | 270 | |
| Ln XMW 5004 | 2,8 | | 195 | 3,5 | | 227 | 4,9 | | 312 | 5,6 | | 360 | 6,3 | | 411 | 4,2 | 1,4 | 390 | 4800 | 280 | |
| An XMW 4032 | 3,5 | | 227 | 4,2 | | 266 | 5,6 | | 360 | 6,3 | | 411 | 7,0 | | 453 | 5,6 | 2,8 | 380 | 5900 | 240 | |
| SUN 3102 | 1,8 | | 235 | 1,8 | | 235 | 2,5 | | 300 | 3,9 | | 410 | | | | 1,8 | 0,2 | 290 | 3000 | 200 | |
| | 2,1 | | 260 | 2,1 | | 260 | 2,8 | | 330 | 4,2 | | 445 | | | | 2,8 | 0,2 | 300 | 3400 | 200 | |
| | 2,5 | | 300 | 2,5 | | 300 | 3,2 | | 355 | 4,6 | | 480 | | | | 2,8 | 0,3 | 300 | 4000 | 200 | |
| | 2,8 | 36 | 330 | 2,8 | 45 | 330 | 3,5 | 68 | 380 | 4,9 | 100 | 529 | | | | 3,5 | 0,7 | 320 | 4300 | 220 | |
| | 3,2 | | 355 | 3,2 | | 355 | 3,9 | | 410 | 5,3 | | 565 | | | | 3,9 | 1,5 | 340 | 4600 | 220 | |
| | 3,5 | | 380 | 3,5 | | 380 | 4,2 | | 445 | 5,6 | | 600 | | | | 4,2 | 1,0 | 330 | 4700 | 230 | |
| Ln XMW 5008 | 4,2 | | 445 | 4,2 | | 445 | 4,9 | | 520 | 6,3 | | 685 | | | | 4,9 | 1,5 | 340 | 5500 | 230 | |
| An XMW 4034 | | | | | | | | | | | | | | | | | | | | | |
| SUW 3141 | 0,7 | | 102 | 1,1 | | 130 | 1,8 | | 184 | 3,2 | | 285 | 5,3 | | 430 | 2,8 | 0,7 | 810 | 4000 | 580 | |
| | 1,1 | 36 | 130 | 1,4 | 45 | 156 | 2,1 | 68 | 210 | 3,5 | 100 | 310 | 6,0 | 141 | 475 | 3,2 | 1,5 | 790 | 4300 | 580 | |
| | 1,4 | | 156 | 2,1 | | 210 | 2,8 | | 260 | 4,9 | | 405 | 6,7 | | 525 | 5,6 | 1,5 | 660 | 5800 | 510 | |
| | 1,8 | | 184 | 2,5 | | 235 | 3,2 | | 285 | 5,9 | | 455 | 7,0 | | 550 | 3,9 | 2,0 | 840 | 4300 | 640 | |
| An XMW 4033 | | | | | | | | | | | | | | | | | | | | | |
| SUN 3175 | 2,1 | | 260 | 2,8 | | 330 | 3,9 | | 410 | 4,9 | | 520 | | | | 2,1 | 0,2 | 340 | 3500 | 240 | |
| | 2,5 | | 300 | 3,2 | | 355 | 4,2 | | 445 | 5,3 | | 565 | | | | 3,2 | 0,2 | 360 | 4300 | 240 | |
| | 2,8 | | 330 | 3,5 | | 380 | 4,6 | | 480 | 5,6 | | 600 | | | | 3,9 | 0,3 | 360 | 4900 | 250 | |
| | 3,2 | 64 | 355 | 3,9 | 78 | 410 | 4,9 | 119 | 520 | 6,0 | 175 | 640 | | | | 4,9 | 0,7 | 360 | 5500 | 250 | |
| | 3,5 | | 380 | 4,2 | | 445 | 5,3 | | 565 | 6,3 | | 685 | | | | 4,9 | 1,5 | 380 | 5500 | 250 | |
| | 4,2 | | 445 | 4,9 | | 520 | 5,6 | | 600 | 6,3 | | | | | | 5,3 | 1,0 | 380 | 5800 | 250 | |
| Ln XMW 5009 | 4,9 | | 520 | 5,6 | | 600 | 6,3 | | 685 | | | | | | | 5,6 | 1,5 | 380 | 6100 | 250 | |
| An XMW 4034 | | | | | | | | | | | | | | | | | | | | | |
| SUN 3280 | 2,8 | | 330 | 3,5 | | 380 | 4,6 | | 480 | 5,6 | | 600 | | | | 2,8 | 0,2 | 360 | 4600 | 250 | |
| | 3,2 | | 355 | 3,9 | | 410 | 4,9 | | 520 | 6,0 | | 640 | | | | 3,9 | 0,2 | 370 | 4900 | 250 | |
| | 3,5 | | 380 | 4,2 | | 445 | 5,3 | | 565 | 6,3 | | 685 | | | | 4,6 | 0,3 | 370 | 5200 | 250 | |
| | 3,9 | 102 | 410 | 4,6 | 125 | 480 | 5,6 | 192 | 600 | | 280 | | | | | 5,3 | 0,7 | 380 | 5500 | 270 | |
| | 4,2 | | 445 | 4,9 | | 520 | 6,0 | | 640 | | | | | | | 5,6 | 1,0 | 410 | 5500 | 270 | |
| | 4,6 | | 480 | 5,3 | | 565 | 6,3 | | 685 | | | | | | | 5,6 | 1,5 | 410 | 5800 | 270 | |
| Ln XMW 5005 | 4,9 | | 520 | 5,6 | | 600 | | | | | | | | | | 6,0 | 1,5 | 410 | 6100 | 270 | |
| An XMW 4034 | | | | | | | | | | | | | | | | | | | | | |

0,2

0,3

0,7

1,5

3,0

Liquid pressure (bar)

GENERAL INFORMATION

MW



STANDARD BODY

When atomizers offering higher capacity values are required it is necessary to use larger size types, as shown in the following pages.

These larger atomizers, with several set-ups types, offer a liquid capacity range from 32 to 1158 liters per hour (lph).

The large size standard body has 1/2" female thread connections, while there is no automatic body available in this size.



The atomizer body can be completed with the usual choice of options as shown in the following.

MWB 1520 B1 B

MATERIALS

- B1 = Aisi 303 stainless steel
- B3 = Aisi 316 stainless steel
- D1 = PVC
- T8 = Nickel plated brass

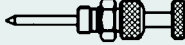
OPTIONS

- A  STANDARD
- B  SHUT-OFF NEEDLE
- C  CLEANING NEEDLE
- D  CLEANING AND SHUT-OFF NEEDLE

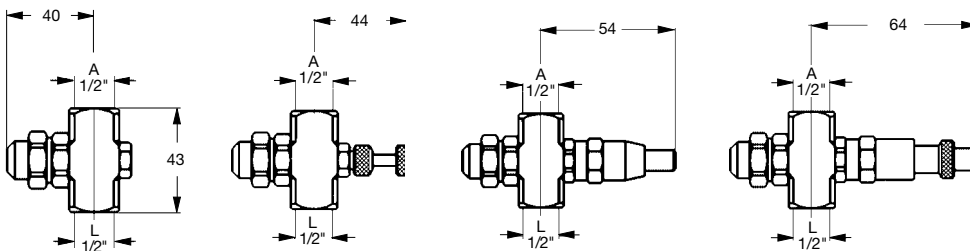

A = 1/2" Air inlet
L = 1/2" Liquid inlet

1/2" SIZE

PRESSURE PRINCIPLE

LARGER CAPACITIES

Larger capacities can be obtained from the set-ups shown in this page, working exclusively on the internal mix principle and fluid pressure feed. Please note the larger dimensions for set-up and body, as shown in the diagrams on the left page. Approximate jet dimensions are given in the table on the right, for the different sizes, and advice on spray adjustment at page 8.

- Materials T8 Nickel plated brass
- B1 AISI 303 stainless steel
- B3 AISI 316 stainless steel
- D1 PVC

INTERNAL MIX SET-UPS

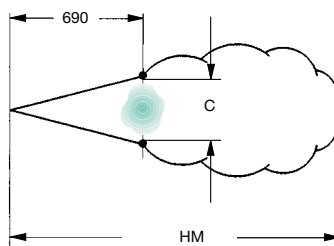

L = Water capacity (lph)
A = Air capacity (N-lpm)

| Set-up Code | Air pressure (bar) | | | | | | | | | | | | | | | | | | |
|---|--------------------|------|-----|-----|-----|-----|-----|-----|------|-----|-----|------|-----|------|------|-----|-----|------|-------|
| | L | | A | | L | | A | | L | | A | | L | | A | | PA | PL | C |
| SUL 3316 Ln XMW 5201 An XMW 4110 | | | | | | | 2,1 | 213 | 176 | 3,1 | 316 | 214 | 4,2 | 238 | 351 | 2,1 | 2 | 690 | 6700 |
| | | | | | | | 2,3 | 127 | 249 | 3,2 | 195 | 292 | 4,3 | 154 | 439 | 3,2 | 3 | 690 | 7300 |
| | | | | | | | | | | 3,4 | 107 | 371 | 4,5 | 100 | 521 | 4,3 | 4 | 690 | 8500 |
| SUL 3192 Ln XMW 5201 An XMW 4111 | 0,6 | 102 | 184 | 1,1 | 215 | 153 | 2,5 | 185 | 355 | 3,7 | 192 | 560 | 5,0 | 230 | 830 | 0,7 | 0,4 | 650 | 6100 |
| | 0,7 | 57 | 230 | 1,3 | 124 | 230 | 2,7 | 146 | 410 | 3,9 | 150 | 620 | 5,3 | 158 | 940 | 1,3 | 1,0 | 670 | 7900 |
| | 0,9 | 32 | 280 | 1,4 | 84 | 280 | 2,8 | 112 | 465 | 4,0 | 119 | 680 | 5,6 | 108 | 1080 | 2,8 | 2,0 | 650 | 6400 |
| | | | | 3,0 | 86 | 520 | 4,2 | 86 | 770 | | | | | | | 4,0 | 3,0 | 670 | 7300 |
| | | | | 3,1 | 65 | 580 | 4,6 | 51 | 910 | | | | | | | 5,3 | 4,0 | 690 | 8200 |
| SUL 3300 Ln XMW 5201 An XMW 4112 | 0,7 | 129 | 325 | 1,7 | 182 | 540 | 3,1 | 265 | 810 | 4,3 | 350 | 1000 | | | | 0,9 | 0,4 | 690 | 7900 |
| | 0,9 | 82 | 370 | 1,8 | 143 | 590 | 3,2 | 215 | 860 | 4,6 | 260 | 1080 | | | | 1,7 | 1,0 | 660 | 7300 |
| | 1,0 | 45 | 415 | | | | 3,4 | 173 | 910 | 5,0 | 186 | 1200 | | | | 3,4 | 2,0 | 660 | 7000 |
| | | | | 3,5 | 136 | 950 | | | | | | | | | | 4,6 | 3,0 | 690 | 8500 |
| SUL 3740 Ln XMW 5202 An XMW 4113 | 0,7 | 134 | 315 | 1,3 | 320 | 440 | 2,1 | 575 | 570 | 3,0 | 740 | 710 | 3,9 | 840 | 860 | 0,7 | 0,4 | 910 | 3400 |
| | 0,9 | 100 | 380 | 1,4 | 255 | 520 | 2,2 | 505 | 640 | 3,1 | 690 | 770 | 4,1 | 790 | 930 | 1,4 | 1,0 | 910 | 4900 |
| | | | | 1,5 | 200 | 590 | 2,4 | 440 | 720 | 3,2 | 630 | 840 | 4,2 | 740 | 990 | 2,5 | 2,0 | 810 | 6100 |
| | | | | 1,7 | 154 | 670 | 2,5 | 380 | 790 | 3,4 | 570 | 910 | 4,4 | 690 | 1070 | 3,4 | 3,0 | 740 | 6700 |
| | | | | | | | 2,7 | 330 | 860 | 3,5 | 520 | 980 | 4,5 | 650 | 1140 | 4,5 | 4,0 | 730 | 7600 |
| | | | | | | | 2,8 | 275 | 930 | 3,7 | 470 | 1050 | 4,6 | 600 | 1210 | | | | |
| | | | | | | | 3,0 | 235 | 1010 | 3,8 | 420 | 1120 | 4,8 | 550 | 1280 | | | | |
| | | | | | | | 3,1 | 195 | 1080 | 3,9 | 345 | 1190 | 4,9 | 510 | 1350 | | | | |
| | | | | | | | | | | 4,1 | 325 | 1260 | 5,1 | 465 | 1430 | | | | |
| | | | | | | | | | | | | | 5,2 | 425 | 1490 | | | | |
| | | | | | | | | | | | | | 5,3 | 390 | 1560 | | | | |
| | | | | | | | | | | | | 5,5 | 350 | 1640 | | | | | |
| SUB 3230 Ln XMW 5201 An XMW 4101 | 1,3 | 34 | 350 | 1,7 | 146 | 365 | 3,0 | 230 | 510 | | | | | | | 1,4 | 0,4 | | 6700 |
| | 1,4 | 25 | 390 | 1,8 | 121 | 395 | 3,1 | 200 | 550 | | | | | | | 2,0 | 1,0 | 250 | 7300 |
| | 1,5 | 20 | 415 | 2,0 | 102 | 430 | 3,2 | 176 | 590 | | | | | | | 3,2 | 2,0 | | 8200 |
| | 1,7 | 15,5 | 445 | 2,1 | 86 | 460 | 3,4 | 154 | 620 | | | | | | | | | | |
| | | | | 2,3 | 72 | 490 | 3,5 | 135 | 660 | | | | | | | | | | |
| SUB 3740 Ln XMW 5202 An XMW 4102 | 0,7 | 134 | 315 | 1,3 | 320 | 440 | 2,1 | 575 | 570 | 3,0 | 740 | 710 | 3,9 | 840 | 860 | 0,7 | 0,4 | 230 | 7000 |
| | 0,9 | 100 | 380 | 1,4 | 255 | 520 | 2,2 | 505 | 640 | 3,1 | 690 | 770 | 4,1 | 790 | 930 | 1,4 | 1,0 | 280 | 6400 |
| | | | | 1,5 | 200 | 590 | 2,4 | 440 | 720 | 3,2 | 630 | 840 | 4,2 | 740 | 990 | 2,5 | 2,0 | 250 | 11300 |
| | | | | 1,7 | 154 | 670 | 2,5 | 380 | 790 | 3,4 | 570 | 910 | 4,4 | 690 | 1070 | 3,4 | 3,0 | 250 | 12500 |
| | | | | | | | 2,7 | 330 | 860 | 3,5 | 520 | 980 | 4,5 | 650 | 1140 | 4,5 | 4,0 | 250 | 14300 |
| | | | | | | | 2,8 | 275 | 930 | 3,7 | 470 | 1050 | 4,6 | 600 | 1210 | | | | |
| | | | | | | | 3,0 | 235 | 1010 | 3,8 | 420 | 1120 | 4,8 | 550 | 1280 | | | | |
| | | | | | | | 3,1 | 195 | 1080 | 3,9 | 345 | 1190 | 4,9 | 510 | 1350 | | | | |
| | | | | | | | | | | 4,1 | 325 | 1260 | 5,1 | 465 | 1430 | | | | |
| | | | | | | | | | | | | | 5,2 | 425 | 1490 | | | | |
| | | | | | | | | | | | | | 5,3 | 390 | 1560 | | | | |
| | | | | | | | | | | | | 5,5 | 350 | 1640 | | | | | |
| SUM 3184 Ln XMW 5201 An XMW 4120 | | | | 1,8 | 154 | 590 | 3,4 | 184 | 950 | | | | | | | 2,0 | 1,0 | 910 | 5800 |
| | | | | 2,0 | 119 | 640 | 3,5 | 157 | 1010 | | | | | | | 3,5 | 2,0 | 970 | 7000 |
| | | | | 2,1 | 93 | 690 | 3,7 | 133 | 1060 | | | | | | | | | | |
| | | | | | | | 3,8 | 112 | 1110 | | | | | | | | | | |
| SUQ 3740 Ln XMW 5202 An XMW 4121 | 0,7 | 134 | 315 | 1,3 | 320 | 440 | 2,1 | 575 | 570 | 3,0 | 740 | 710 | 3,9 | 840 | 860 | 0,7 | 0,4 | 1190 | 4000 |
| | 0,9 | 100 | 380 | 1,4 | 255 | 520 | 2,2 | 505 | 640 | 3,1 | 690 | 770 | 4,1 | 790 | 930 | 1,4 | 1,0 | 2110 | 4600 |
| | | | | 1,5 | 200 | 590 | 2,4 | 440 | 720 | 3,2 | 630 | 840 | 4,2 | 740 | 990 | 2,5 | 2,0 | 2080 | 5200 |
| | | | | 1,7 | 154 | 670 | 2,5 | 380 | 790 | 3,4 | 570 | 910 | 4,4 | 690 | 1070 | 3,4 | 3,0 | 2160 | 5800 |
| | | | | | | | 2,7 | 330 | 860 | 3,5 | 520 | 980 | 4,5 | 650 | 1140 | 4,5 | 4,0 | 2260 | 6400 |
| | | | | | | | 2,8 | 275 | 930 | 3,7 | 470 | 1050 | 4,6 | 600 | 1210 | | | | |
| | | | | | | | 3,0 | 235 | 1010 | 3,8 | 420 | 1120 | 4,8 | 550 | 1280 | | | | |
| | | | | | | | 3,1 | 195 | 1080 | 3,9 | 345 | 1190 | 4,9 | 510 | 1350 | | | | |
| | | | | | | | | | | 4,1 | 325 | 1260 | 5,1 | 465 | 1430 | | | | |
| | | | | | | | | | | | | | 5,2 | 425 | 1490 | | | | |
| | | | | | | | | | | | | | 5,3 | 390 | 1560 | | | | |
| | | | | | | | | | | | | 5,5 | 350 | 1640 | | | | | |

WIDE ANGLE ROUND SPRAY

ROUND SPRAY

FLAT SPRAY

0,35

1,0

2,0

3,0

4,0

Liquid pressure (bar)

LARGER CAPACITIES

EXTERNAL MIX - FLAT SPRAY

| Set-up Code | Air pressure (bar) | | | | | | | | | | | | | | | | | | | |
|---|------------------------------|-----|-------------|-----|------------|------|------------|-----|----------|-----|-----|------|-----|------|------|-----|-----|-----|------|----|
| | L | | A | | L | | A | | L | | A | | L | | A | | PA | PL | C | HM |
| SUM 4195 Ln XMW 5001 An XMW 4035 | 2,1 | | 877 | 2,8 | | 1075 | 3,2 | | 1174 | 3,9 | | 1358 | 5,6 | | 1839 | 2,5 | 0,2 | 520 | 5800 | |
| | 2,4 | | 962 | 3,2 | | 1174 | 3,5 | | 1273 | 4,2 | | 1457 | 6,0 | | 1952 | 3,5 | 0,4 | 550 | 6700 | |
| | 2,8 | 522 | 1075 | 3,5 | 681 | 1273 | 3,9 | 795 | 1358 | 4,9 | 953 | 1641 | 6,3 | 1158 | 2037 | 3,9 | 0,5 | 580 | 7020 | |
| | 3,2 | | 1174 | 3,9 | | 1457 | 4,2 | | 1556 | 5,3 | | 1754 | 6,6 | | 2122 | 4,9 | 0,7 | 610 | 7630 | |
| | | | | 4,2 | | 1457 | 4,6 | | 1641 | 6,0 | | 1839 | 7,0 | | 2207 | 6,3 | 1,0 | 660 | 8850 | |
| | 0,2 | | 0,35 | | 0,5 | | 0,7 | | 1 | | | | | | | | | | | |
| | Liquid pressure (bar) | | | | | | | | | | | | | | | | | | | |

INTERNAL MIX - HOLLOW CONE SPRAY

| Set-up Code | Air pressure (bar) | | | | | | | | | | | | | | | | | | |
|---|------------------------------|-------|------------|-----|------------|-----|------------|-----|------------|-----|-----|------|-----|-----|------|--|--|--|--|
| | L | | A | | L | | A | | L | | A | | L | | A | | | | |
| SUZ 3460 Ln XMW 5002 An XMW 4046 | 1,0 | 213,0 | 345 | 1,7 | 394 | 453 | 2,5 | 439 | 634 | 3,4 | 462 | 787 | 5,0 | 484 | 1138 | | | | |
| | 1,1 | 145,0 | 418 | 1,8 | 324 | 526 | 2,7 | 372 | 702 | 3,5 | 416 | 843 | 5,2 | 439 | 1197 | | | | |
| | 1,3 | 97,6 | 575 | 2,0 | 275 | 574 | 2,8 | 322 | 750 | 3,7 | 372 | 891 | 5,3 | 409 | 1254 | | | | |
| | 1,4 | 59,0 | 538 | 2,1 | 207 | 642 | 3,0 | 277 | 818 | 3,8 | 325 | 956 | 5,5 | 366 | 1310 | | | | |
| | | | | 2,3 | 159 | 702 | 3,1 | 272 | 874 | 3,9 | 282 | 1019 | 5,6 | 325 | 1367 | | | | |
| | | | | 2,4 | 116 | 758 | 3,2 | 188 | 931 | 4,1 | 250 | 1084 | 5,8 | 297 | 1429 | | | | |
| | | | | 2,5 | 93 | 829 | 3,4 | 145 | 990 | 4,2 | 209 | 1135 | 5,9 | 257 | 1486 | | | | |
| | | | | 2,7 | 27 | 900 | 3,5 | 114 | 1050 | 4,4 | 168 | 1189 | 6,0 | 232 | 1551 | | | | |
| | | | | | | | | | | 4,5 | 141 | 1259 | 6,3 | 182 | 1670 | | | | |
| | | | | | | | | | | 4,6 | 77 | 1296 | | | | | | | |
| | 0,7 | | 1,4 | | 2,1 | | 2,8 | | 4,2 | | | | | | | | | | |
| | Liquid pressure (bar) | | | | | | | | | | | | | | | | | | |

SIPHON SET-UP - ROUND SPRAY

| Set-up Code | Air pressure (bar) | | | | | | | | | | | | | | | | | | |
|---|--------------------------|------|------------|-------|--------------------------|-------|------------|-----|------------|--|------------|--|------------|--|---|--|----|-----|-------|
| | Air capacity (N-lpm) | | | | | | | | | | | | | | | | | | |
| | L | | A | | L | | A | | L | | A | | L | | A | | PA | HM | |
| SUC 2230 Ln XMW 5201 An XMW 4045 | 0,7 | 360 | | | | | | | | | | | | | | | | 1,5 | 6100 |
| | 1,5 | 570 | | | | | | | | | | | | | | | | 2,0 | 6700 |
| | 2,0 | 660 | | | | | | | | | | | | | | | | 3,0 | 7300 |
| | 3,0 | 870 | | | | | | | | | | | | | | | | 3,5 | 7900 |
| | 3,5 | 990 | 300 | 265,0 | 225 | 150 | 123,0 | 90 | | | | | | | | | | 4,0 | 8800 |
| | 4,0 | 1100 | 305 | 270,0 | 240 | 170 | 143,0 | 115 | | | | | | | | | | 5,0 | 9800 |
| | 5,0 | 1300 | 315 | 280,0 | 250 | 183 | 157,0 | 129 | 53 | | | | | | | | | 5,6 | 10700 |
| 5,6 | 1450 | 320 | 290,0 | 255 | 188 | 164,0 | 136 | 62 | | | | | | | | | | | |
| | 450 | | 300 | | 150 | | 100 | | 200 | | 300 | | 600 | | | | | | |
| | Gravity head (mm) | | | | Suction head (mm) | | | | | | | | | | | | | | |

OPTIONS AND ACCESSORIES

SINGLE AIR INLET (U option)

MX atomizers can be supplied with a single air inlet port, feeding both nozzle and shut-off cylinder.

This design requires only one air valve, and stops air flow when no spray is required.

However, the liquid trapped in the nozzle at shut-off time will be atomized with low/no air pressure, with the result of some dripping at the end of each spray cycle.

This option should be considered where the time between two spraying cycles is relatively important, some liquid dripping can be tolerated and system cost is a prime factor.



SPECIAL NOZZLE COATINGS

A range of high technology coatings are available to our customers upon request, to solve problems such as solid lime build-up or excessive wear on both liquid and air nozzles.

These include coating with Teflon® and different types of extra hard linings to suit various operation requirements.

Our offices will gladly assist you with the selection of the best solution to your problems.



SPECIAL PURPOSE BODIES

Our Engineering Office can study, design and test special bodies and assembly systems to solve your specific application problems.

We can supply under confidentiality agreement special parts, specifically designed for individual customers needs, which are not advertised.



WALL MOUNTING NIPPLES

These specially designed nipples make it possible to efficiently operate a standard MW atomizer directly through the wall of tanks, or through steel sheet air ducts, without need of any other additional part or assembly fittings.

Two different models, for thin or thick walls, are available.

See our Accessories Catalogue CTG AC15 BR for details and product codes.



PRESSURE TANKS

Portable pressure tanks use compressed air to pressurize the liquid, and make it possible to operate air atomizers anywhere, without depending upon a liquid pump, or even a compressed air net.

Portable pressure tanks are made out AISI 304 grade stainless steel, with quick couplings for feed hoses, pressure tight lid, tank base and top protected by a thick rubber coating.

Details and product codes on our Accessories Catalogue CTG AC15 BR.



AMBIENT HUMIDIFICATION SYSTEMS



Page 23



Page 24

Keeping the air humidity level within the correct values in a given ambient, either in still or flowing air, can serve different purposes in a large number of industrial applications, where the material or the product being processed must be maintained in a controlled humidity condition.

In other cases an atomizing system can be used to keep ambient temperature under control by means of evaporative cooling, or be used for flying dust abatement, ambient disinfection, or even to assist an existing fire fighting system.

Performing this operation in an efficient way requires professional, well proven and reliable equipment, like our standard products shown in the following pages.

PNR Offices and Distributors can gladly supply you with additional information about how you can design and calculate your own humidification system in a fast and efficient way.

AMBIENT HUMIDIFICATION SYSTEMS

PNR automatic atomizers, MX series, and ultrasonic atomizers, MA series, are widely used as the atomizing devices for industrial humidification systems.

In the following page they are shown fitted with the accessories that make them ready for an easy and efficient installation with professional results.

Our standard control cabinets have been designed to assure safe and flexible operation for humidification systems, and proved to offer outstanding performances along years of reliable operation.

All internal components and electronic devices have been carefully chosen to assure reliability and top quality performances.

Each single cabinet is assembled and tested in our own facilities prior to delivery.

ATOMIZING DEVICES

MX ATOMIZERS

An automatic atomizer, MX series, with the convenience of its built-in air operated cylinder controlling the liquid feed, is a very efficient atomizing device for any humidification system.

They can be delivered in two different types, that is with two different air inlet ports for atomizing air and cylinder control air, or with a single air inlet port serving the two functions. In the latter case a minimum air pressure value of 2 bar is required.

Our unique drip-free shut-off needle assures perfect operation and avoids any danger of originating wet spots on the ground.

A swivel joint assembly allows for easy orientation of the atomized spray in the most convenient direction, so as to obtain optimum distribution of the evaporating droplets into the ambient air.

Liquid and air nozzles are protected by a special surface coating against the danger of lime build-up from hard water, to assure minimum maintenance cost.

These atomizers can be delivered in Nickel plated brass or Aisi 303 Stainless steel.

RECOMMENDED MODELS

| | | |
|----------------------|-----------------|------------------|
| MXB 2142 B1B | Stainless steel | Two air inlets |
| MXB 2142 B1BU | | Single air inlet |
| MXB 2142 T8B | Brass | Two air inlets |
| MXB 2142 T8BU | | Single air inlet |



ULTRASONIC ATOMIZERS

Thanks to their optimum efficiency, ultrasonic atomizers are the best solution to produce the very fine mists required in humidification and disinfection systems, with an overall limited operating cost. They offer a long throw with an excellent evaporation rate.

However, their principle of operation requires sound waves to be produced and the consequent operational noise restricts their use to such systems where personnel is not exposed to noise levels exceeding the limit values specified by local safety regulations.

TYPES AVAILABLE

Electric drive

The atomizer is assembled onto a PVC body containing an electrovalve for water inlet, which allows for a drip-free operation. Each single atomizer has to be connected to the electric power line (220 V, 48 V or 24 V available).

Pneumatic drive

The atomizer is assembled onto a stainless steel body, where the water inlet is operated by an air pilot valve: water feed is automatically closed when air pressure falls lower than 2.5 bar. This system is very easy to be assembled since it does not require any electrical wiring, the limit being that the air driven pilot valve can only be used with plain water.

Both types are supplied complete with:

- Wall attachments in stainless steel. With swivel joint
- Quick connection fittings for air and water

RECOMMENDED ATOMIZERS

MAD 1131 B1

MAD 0802 B1

Contact our offices for further details.



CONTROL PANELS



HYDRO PNEUMATIC CABINET

Manual control cabinets are the simple and cost convenient solution for the fine tuning the operation of a complete humidification system, whatever atomizer types is used. The system can be set to produce a lighter or heavier mist according to the user requirements, just setting the pressure values for air and water to different values.

Our cabinets, which come pre-assembled and complete with all necessary devices to control air and liquid lines, offer the convenience of a tested ready-assembled unit, whose design has been optimized for the application.

Maximum System Capacity

| Code | | | | Maximum System Capacity | |
|-------------|------|------|------|-------------------------|----------|
| | L | AA | AC | MXB 2142 | MAD 1131 |
| UMQ AA01 V0 | 1/4" | 3/8" | 1/4" | 20 | 6 |
| UMQ AA02 V0 | 3/8" | 1/2" | 1/4" | 40 | 12 |
| UMQ AB01 V0 | 1/4" | 3/8" | * | 20 | 6 |
| UMQ AB02 V0 | 3/8" | 1/2" | * | 40 | 12 |

L = Water inlet

AA = Atomizing air

AC = Cylinder drive air

* These cabinets have one only air line

They are equipped with:

- Inlet ball valves for air and water
- First water filter, 100 micron
- Fine water filter, 5 micron
- Air filter, 100 micron
- Electrovalves, for air and water lines
- Pressure regulators, for air and water, with inlet and outlet control manometer.
- System drain ball valves for air and water.

Cabinets have a steel body, protected with epoxy paint (stainless steel on request).

IP 55.9 electrical protection grade.

The table below shows the product code with reference to the the size of feed lines for air and water.

More detailed information is available on Data Sheet 9197.

HUMIDITY CONTROL CABINET

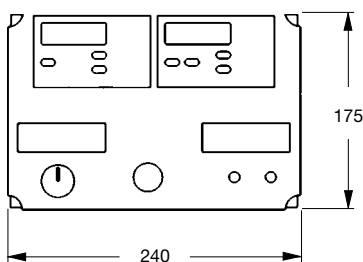

This modern cabinet makes available to our Customer the most advanced equipment on the market.

It offers the safety and convenience of a pre-programmed microprocessor unit which not only performs all the control work for A fully automatic system operation, but has the added possibility of an easy atomizing cycle TIME adjustment to cope with any given requirement.

- The system can be operated in Manual (On/Off) or Automatic mode.
- Automatic programming for continuous operation or spray/idle cycles
- Push button pre-setting of desired humidity and temperature values
- Digital reading for actual humidity and temperature values
- Automatic stop if actual temperature lower than preset value
- Delivery includes tem,perature/humidity sensor
- 220 V, 50 Hz power feed

Product Code **UMQ B001 V0**

Further details on Data Sheet 9198

GENERAL INFORMATION

ABBREVIATIONS

| | | | | | | | | |
|-----------|------------------|-------|-----------|-----------------------|-----|----------|----------------|-----|
| A | AIR CAPACITY | N-lpm | HR | COHERENT SPRAY LENGTH | mm | W | WATER CAPACITY | lpm |
| AN | AIR NOZZLE | - | L | WATER CAPACITY | lph | | | |
| C | WIDTH OF SPRAY | mm | LN | LIQUID NOZZLE CODE | - | | | |
| CH | WRENCH SIZE | mm | PA | AIR PRESSURE | bar | | | |
| HM | MAX SPRAY LENGTH | mm | PL | WATER PRESSURE | bar | | | |

PRODUCT WARRANTY

Pnr products will be replaced or repaired, at the option of Pnr and free of charges, if found defective in manufacturing, labeling or packaging.

The above warranty conditions will apply if notice of defect is received by Pnr within 30 days from date of product installation or one year from date of shipment.

The cost of above said replacement or repair shall be the exclusive remedy for any breach of any warranty, and Pnr shall not be held liable for any damage due to personal injuries or commercial losses coming from product malfunction.

Our Company Procedure for warranty requires the following steps:

- 1 Contact our Quality Manager and obtain from Pnr a return authorization number
- 2 Return the products together with our form 3DA A04 duly filled
- 3 We shall issue a test report, send you a copy and return the product (replaced or repaired).

Our Company scope is obtaining full Customer satisfaction, and we are fully aware of the inconvenience which can be originated from a defective product.

Please be assured we shall do our best to make available a perfect product in the shortest possible time.

We also provide, for products which are not defective, a product return policy as follows.

PRODUCTS DELIVERED IN ERROR FROM PNR

- 1 Obtain from Pnr a return authorization number
- 2 Return the products together with our form duly filled
- 3 Pnr shall issue a Credit Note for full product and shipping costs.

PRODUCTS ORDERED INCORRECTLY TO PNR

- 1 Obtain from Pnr a return authorization number
- 2 Return the products, at your expense, together with our form duly filled
- 3 Products shall be in original conditions, inside the original packing
- 4 A re-stocking charge of 15% applies.

NON CATALOG PRODUCTS

Can only be returned after a quotation from Pnr is obtained.

SENDING LIST

In order to receive automatically updates of our Catalogues, please photocopy the card below and mail it to any Pnr Office in a sealed envelope.

Your details will be recorded into our permanent mailing list.

CTG AZ15 BR

| | | | | |
|----|----------|--------|----------------------------|--|
| 01 | COMPANY | | SPRAY NOZZLES | |
| 02 | NAME | | AIR ASSISTED ATOMIZERS | |
| 03 | FUNCTION | | EVAPORATIVE COOLING LANCES | |
| 04 | ADRESS | | SPRAYDRY NOZZLES | |
| 05 | PHONE | FAX | TANK WASHING SYSTEMS | |
| 06 | WEB SITE | E-MAIL | ACCESSORIES AND FITTINGS | |

PNR UK LTD

16, Sugarbrook Rd - Aston Fields Ind. Estate
BROMSGROVE WORCS B60 3DW
Tel. (01527) 579066 - Fax (01527) 579067
www.pnr-nozzles.com - E-mail: spraynozzles@pnr.co.uk

CTG AZ15 BR



Our products are distributed through:

PNR America
PNR Asia
PNR Benelux

PNR Brasil
PNR Czech Republic
PNR Deutschland
PNR France

PNR Italia
PNR Mexico
PNR U. Kingdom

We are moreover represented in:

Argentina
Australia
Austria
Canada
Chile
Denmark
Finland
Greece
India

Indonesia
Iran
Ireland
Japan
Slovenia
Korea
Nepal
Norway
N. Zealand

Pakistan
Poland
Portugal
Singapore
South Africa
Spain
Sweden
Taiwan
Venezuela

